

VENEZIA ENGINEERING SUPPLIES & FASTENERS

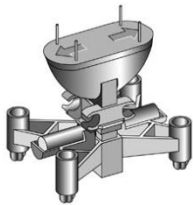

MAY 2012 PRODUCT LIST

P: (02) 9756 2756 F: (02) 9756 2757 E: zoran@veneziaengineering.com

INDUSTRIAL

MILD STEEL

BSW Bolts & Nuts	5-7
BSW Set Screws	8-9
Metric 4.6 Bolts & Nuts	10-33
Metric 4.6 Set Screws	33-37
BSW Cup Head Bolts & Nuts	37-40
Metric Cup Head Bolts & Nuts	41-50
Coach Screws	50-55

STRUCTURAL

Metric Bolt, Nut & Washers Assemblies	56-61
Metric Structural Nuts	61-62
Metric Structural Washers	62-63
Metric Load Indicating Washers	63

HIGH TENSILE

UNC Grade 5 Bolts & Nuts	64-69
UNC Grade 8 Bolts & Nuts	69-81
UNF Grade 5 Bolts & Nuts	81-87
UNF/UNS Grade 8 Bolts & Nuts	88-97
Metric Class 8.8 Bolts & Nuts	98-112
Metric Class 8.8 Set Screws	112-115

THREADED ROD

Threaded Rod Metric 4.6 DIN 975	115-118
Threaded Rod Metric 8.8 DIN 975	118-119

W
V
U
T
S
R
Q
P
O
N
M
L
K
J
I
H
G
F
E
D
C
B
A

INDUSTRIAL

NUTS

Hex Couping Nuts	120
Hexagon Nuts Class 8	121-123
Hexagon Nuts Class 5	124

WASHERS

Flat Round Washers	125
Square Flat Washers	126

TURNBUCKLES

Turnbuckles Stub/E-Galvanised	127
-------------------------------	-----

PURLIN FACIA BOLTS

Purlin Facia Bolt	128
-------------------	-----

< N M Z K
 A - N M Z K
 M Z - O Z
 O Z - M M Z - O Z
 O Z - M M Z
 O M - F U V C O
 O M - F U V C O
 O Z A
 L
 O M Z M H O A T
 O M Z M H O A T

VARIOUS PRODUCTS

0 1 2 3 4 5 6 7 8 9 A B C D E F G H I J K L M N O P Q R S T U V W X Y Z	FERRULES 130-132 GROUT/SILICON/SEALANTS/BACKER RODS 132 STARTER BARS 132 GROUT LIFTER & BRACE FERRULE PATCH CAPS 133 VENEZIA PANEL PROP BRACE HIRE 133 ANGLE CONNECTION/FLAT PLATES/PANEL CLIPS/BOLTS 134 FILLET/WINGED FILET/FALSE JOINT/DOUBLE SIDED TAPES 134 FILLET CUTTER 134 DOWEL POCKETS / DOWEL INSERTS 135 FOOT ANCHORS 135 EYE ANCHORS 136 SWIFT LIFT LIFTING CLUTCHES 136 RUBBER/STEEL RECESS FORMERS 137 PLASTIC RECESS FORMER 137 ARTICULATED RECESS FORMER 137 RUBBER RINGS 138 2.5 & 5.0 TONNE FOOT STYLE EDGELIFT SYSTEM 138 HAIRPIN EDGELIFT SYSTEM 138 RAMSET TILT UP SETS 139 REID TILT UP SETS 139 PANEL LEVER BAR 139 BONDBREAKER/SPRAYER 140 CLIP ON BAR CHAIRS 140 CLIP ON MESH CHAIRS 141 PANEL MESH CHAIRS 141 FERRULE CHAIRS 141 FERRULE CHAIRS DOWELS 141 PACKING SHIMS 142 HALF SHIMS 142 HORSE SHOE SHIMS LONG 143 NAILING PLATES/GLUE ON PLATES 143 ANTENNA CAPS 143
--	--



HEXAGON HEAD BOLTS & NUTS

ZINC PLATED

BSW AS 2451 – 1998

DIAMETER INCHES	LENGTH INCHES	STANDARD PACK
¼ 20 TPI	¾	150
¼ 20 TPI	1	150
¼ 20 TPI	1. ¼	150
¼ 20 TPI	1. ½	150
¼ 20 TPI	1. ¾	150
¼ 20 TPI	2	150
¼ 20 TPI	2. ¼	150
¼ 20 TPI	2. ½	150
¼ 20 TPI	2. ¾	150
¼ 20 TPI	3	150
¼ 20 TPI	3. ½	150
¼ 20 TPI	4	150
¼ 20 TPI	4. ½	100
¼ 20 TPI	5	100
¼ 20 TPI	5. ½	100
¼ 20 TPI	6	100
5/16 18 TPI	¾	150
5/16 18 TPI	1	150
5/16 18 TPI	1. ¼	150
5/16 18 TPI	1. ½	150
5/16 18 TPI	1. ¾	150
5/16 18 TPI	2	150
5/16 18 TPI	2. ¼	150
5/16 18 TPI	2. ½	150
5/16 18 TPI	2. ¾	100
5/16 18 TPI	3	100
5/16 18 TPI	3. ½	100
5/16 18 TPI	4	100
5/16 18 TPI	4. ½	100
5/16 18 TPI	5	100
5/16 18 TPI	5. ½	100
5/16 18 TPI	6	100



HEXAGON HEAD BOLTS & NUTS

ZINC PLATED

BSW AS 2451 – 1998

DIAMETER INCHES	LENGTH INCHES	STANDARD PACK
3/8 16 TPI	3/4	150
3/8 16 TPI	1	150
3/8 16 TPI	1. 1/4	150
3/8 16 TPI	1. 1/2	150
3/8 16 TPI	1. 3/4	150
3/8 16 TPI	2	100
3/8 16 TPI	2. 1/4	100
3/8 16 TPI	2. 1/2	100
3/8 16 TPI	2. 3/4	100
3/8 16 TPI	3	100
3/8 16 TPI	3. 1/2	50
3/8 16 TPI	4	50
3/8 16 TPI	4. 1/2	50
3/8 16 TPI	5	50
3/8 16 TPI	5. 1/2	50
3/8 16 TPI	6	50
1/2 12 TPI	1	25
1/2 12 TPI	1. 1/4	25
1/2 12 TPI	1. 1/2	25
1/2 12 TPI	1. 3/4	25
1/2 12 TPI	2	25
1/2 12 TPI	2. 1/4	25
1/2 12 TPI	2. 1/2	25
1/2 12 TPI	3	25
1/2 12 TPI	3. 1/2	25
1/2 12 TPI	4	25
1/2 12 TPI	4. 1/2	25
1/2 12 TPI	5	25
1/2 12 TPI	5. 1/2	25
1/2 12 TPI	6	25



HEXAGON HEAD BOLTS & NUTS

ZINC PLATED BSW AS 2451 – 1998

DIAMETER INCHES	LENGTH INCHES	STANDARD PACK
5/8 11 TPI	1	20
5/8 11 TPI	1. ¼	20
5/8 11 TPI	1. ½	20
5/8 11 TPI	1. ¾	20
5/8 11 TPI	2	20
5/8 11 TPI	2. ¼	20
5/8 11 TPI	2. ½	20
5/8 11 TPI	2. ¾	20
5/8 11 TPI	3	20
5/8 11 TPI	3. ½	20
5/8 11 TPI	4	20
5/8 11 TPI	4. ½	20
5/8 11 TPI	5	20
5/8 11 TPI	5 ½	20
5/8 11 TPI	6	20
5/8 11 TPI	7	20
5/8 11 TPI	8	20
<hr/>		
¾ 10 TPI	1. ¼	20
¾ 10 TPI	1. ½	20
¾ 10 TPI	1. ¾	20
¾ 10 TPI	2	20
¾ 10 TPI	2. ¼	20
¾ 10 TPI	2. ½	20
¾ 10 TPI	3	20
¾ 10 TPI	3. ½	20
¾ 10 TPI	4	20
¾ 10 TPI	4. ½	20
¾ 10 TPI	5	20
¾ 10 TPI	6	20
¾ 10 TPI	7	20
¾ 10 TPI	8	20



HEXAGON HEAD SET SCREWS

ZINC PLATED

BSW AS 2451 – 1998

DIAMETER INCHES	LENGTH INCHES	STANDARD PACK
¼ 20 TPI	½	200
¼ 20 TPI	¾	200
¼ 20 TPI	1	200
¼ 20 TPI	1. ¼	200
¼ 20 TPI	1. ½	200
¼ 20 TPI	2	200
¼ 20 TPI	2. ½	150
¼ 20 TPI	3	150
5/16 18 TPI	½	200
5/16 18 TPI	¾	200
5/16 18 TPI	1	200
5/16 18 TPI	1. ¼	200
5/16 18 TPI	1. ½	200
5/16 18 TPI	2	200
5/16 18 TPI	2. ½	150
5/16 18 TPI	3	150
3/8 16 TPI	¾	200
3/8 16 TPI	1	200
3/8 16 TPI	1. ¼	200
3/8 16 TPI	1. ½	200
3/8 16 TPI	2	150
3/8 16 TPI	2. ½	150
3/8 16 TPI	3	150
3/8 16 TPI	3. ½	100
3/8 16 TPI	4	100
½ 12 TPI	¾	100
½ 12 TPI	1	100
½ 12 TPI	1 ¼	100
½ 12 TPI	1 ½	100
½ 12 TPI	2	75
½ 12 TPI	2 ½	75
½ 12 TPI	3	75



HEXAGON HEAD SET SCREWS

ZINC PLATED
 BSW AS 2451 – 1998

DIAMETER INCHES	LENGTH INCHES	STANDARD PACK
½ 12 TPI	3 ½	50
½ 12 TPI	4	50
½ 12 TPI	5	25
½ 12 TPI	6	25
5/8 11 TPI	1. ½	50
5/8 11 TPI	2	50
5/8 11 TPI	2. ½	25
5/8 11 TPI	3	25
5/8 11 TPI	4	25

HEXAGON HEAD M6 1.0mm Pitch



BOLTS & NUTS

METRIC 4.6 AS1111 – 2000 / AS1112 – 2000

GALVANISED

DIAMETER mm	LENGTH mm	STANDARD PACK
M6 1.0 mm PITCH	20	200
M6 1.0 mm PITCH	25	200
M6 1.0 mm PITCH	30	200
M6 1.0 mm PITCH	35	200
M6 1.0 mm PITCH	40	200
M6 1.0 mm PITCH	45	200
M6 1.0 mm PITCH	50	200
M6 1.0 mm PITCH	60	150
M6 1.0 mm PITCH	65	150
M6 1.0 mm PITCH	75	150
M6 1.0 mm PITCH	80	150
M6 1.0 mm PITCH	90	150
M6 1.0 mm PITCH	100	150
M6 1.0 mm PITCH	130	100
M6 1.0 mm PITCH	150	100

HEXAGON HEAD M6 1.0mm Pitch



BOLTS & NUTS

METRIC 4.6 AS1111 – 2000 / AS1112 – 2000

ZINC PLATED

DIAMETER mm	LENGTH mm	STANDARD PACK
M6 1.0 mm PITCH	20	200
M6 1.0 mm PITCH	25	200
M6 1.0 mm PITCH	30	200
M6 1.0 mm PITCH	35	200
M6 1.0 mm PITCH	40	200
M6 1.0 mm PITCH	45	200
M6 1.0 mm PITCH	50	200
M6 1.0 mm PITCH	55	150
M6 1.0 mm PITCH	60	150
M6 1.0 mm PITCH	65	150
M6 1.0 mm PITCH	70	150
M6 1.0 mm PITCH	75	150
M6 1.0 mm PITCH	80	150

HEXAGON HEAD M6 1.0mm Pitch



BOLTS & NUTS

METRIC 4.6 AS1111 – 2000 / AS1112 – 2000

ZINC PLATED

DIAMETER mm	LENGTH mm	STANDARD PACK
M6 1.0 mm PITCH	90	150
M6 1.0 mm PITCH	100	150
M6 1.0 mm PITCH	120	100
M6 1.0 mm PITCH	130	100
M6 1.0 mm PITCH	140	100
M6 1.0 mm PITCH	150	100

HEXAGON HEAD M8 1.25mm Pitch**BOLTS & NUTS**

METRIC 4.6 AS1111 – 2000 / AS1112 – 2000

GALVANISED

DIAMETER mm	LENGTH mm	STANDARD PACK
M8 1.25 mm PITCH	20	200
M8 1.25 mm PITCH	25	200
M8 1.25 mm PITCH	30	200
M8 1.25 mm PITCH	35	200
M8 1.25 mm PITCH	40	200
M8 1.25 mm PITCH	45	150
M8 1.25 mm PITCH	50	150
M8 1.25 mm PITCH	55	150
M8 1.25 mm PITCH	60	150
M8 1.25 mm PITCH	65	150
M8 1.25 mm PITCH	70	100
M8 1.25 mm PITCH	75	100
M8 1.25 mm PITCH	80	100
M8 1.25 mm PITCH	90	100
M8 1.25 mm PITCH	100	100
M8 1.25 mm PITCH	120	100
M8 1.25 mm PITCH	130	100
M8 1.25 mm PITCH	150	100

HEXAGON HEAD M8 1.25mm Pitch



BOLTS & NUTS

METRIC 4.6 AS1111 – 2000 / AS1112 – 2000

ZINC PLATED

DIAMETER mm	LENGTH mm	STANDARD PACK
M8 1.25 mm PITCH	20	200
M8 1.25 mm PITCH	25	200
M8 1.25 mm PITCH	30	200
M8 1.25 mm PITCH	35	200
M8 1.25 mm PITCH	40	200
M8 1.25 mm PITCH	45	150
M8 1.25 mm PITCH	50	150
M8 1.25 mm PITCH	55	150
M8 1.25 mm PITCH	60	150
M8 1.25 mm PITCH	65	150
M8 1.25 mm PITCH	70	100
M8 1.25 mm PITCH	75	100
M8 1.25 mm PITCH	80	100
M8 1.25 mm PITCH	90	100
M8 1.25 mm PITCH	100	100
M8 1.25 mm PITCH	120	100
M8 1.25 mm PITCH	130	100
M8 1.25 mm PITCH	150	100

HEXAGON HEAD M10 1.5mm Pitch



BOLTS & NUTS

METRIC 4.6 AS1111 – 2000 / AS1112 – 2000

PLAIN FINISH

DIAMETER mm	LENGTH mm	STANDARD PACK
M10 1.5 mm PITCH	20	150
M10 1.5 mm PITCH	25	150
M10 1.5 mm PITCH	30	150
M10 1.5 mm PITCH	35	150
M10 1.5 mm PITCH	40	150
M10 1.5 mm PITCH	45	150
M10 1.5 mm PITCH	50	75
M10 1.5 mm PITCH	55	75
M10 1.5 mm PITCH	60	75
M10 1.5 mm PITCH	65	75
M10 1.5 mm PITCH	70	75
M10 1.5 mm PITCH	75	75
M10 1.5 mm PITCH	80	75
M10 1.5 mm PITCH	90	50
M10 1.5 mm PITCH	100	50
M10 1.5 mm PITCH	110	50
M10 1.5 mm PITCH	120	50
M10 1.5 mm PITCH	130	50
M10 1.5 mm PITCH	140	50
M10 1.5 mm PITCH	150	50
M10 1.5 mm PITCH	160	100
M10 1.5 mm PITCH	170	100
M10 1.5 mm PITCH	180	100
M10 1.5 mm PITCH	190	100
M10 1.5 mm PITCH	200	100
M10 1.5 mm PITCH	220	75
M10 1.5 mm PITCH	240	75
M10 1.5 mm PITCH	260	75
M10 1.5 mm PITCH	280	50
M10 1.5 mm PITCH	300	50

HEXAGON HEAD M10 1.5mm Pitch



BOLTS & NUTS

METRIC 4.6 AS1111 – 2000 / AS1112 – 2000

GALVANISED

DIAMETER mm	LENGTH mm	STANDARD PACK
M10 1.5 mm PITCH	20	150
M10 1.5 mm PITCH	25	150
M10 1.5 mm PITCH	30	150
M10 1.5 mm PITCH	35	150
M10 1.5 mm PITCH	40	150
M10 1.5 mm PITCH	45	150
M10 1.5 mm PITCH	50	75
M10 1.5 mm PITCH	55	75
M10 1.5 mm PITCH	60	75
M10 1.5 mm PITCH	65	75
M10 1.5 mm PITCH	70	75
M10 1.5 mm PITCH	75	75
M10 1.5 mm PITCH	80	75
M10 1.5 mm PITCH	90	50
M10 1.5 mm PITCH	100	50
M10 1.5 mm PITCH	110	50
M10 1.5 mm PITCH	120	50
M10 1.5 mm PITCH	130	50
M10 1.5 mm PITCH	140	50
M10 1.5 mm PITCH	150	50
M10 1.5 mm PITCH	160	100
M10 1.5 mm PITCH	170	100
M10 1.5 mm PITCH	180	100
M10 1.5 mm PITCH	190	100
M10 1.5 mm PITCH	200	100
M10 1.5 mm PITCH	220	75
M10 1.5 mm PITCH	240	75
M10 1.5 mm PITCH	260	75
M10 1.5 mm PITCH	280	50
M10 1.5 mm PITCH	300	50

HEXAGON HEAD M10 1.5mm Pitch**BOLTS & NUTS**

METRIC 4.6 AS1111 – 2000 / AS1112 – 2000

ZINC PLATED

DIAMETER mm	LENGTH mm	STANDARD PACK
M10 1.5 mm PITCH	20	150
M10 1.5 mm PITCH	25	150
M10 1.5 mm PITCH	30	150
M10 1.5 mm PITCH	35	150
M10 1.5 mm PITCH	40	150
M10 1.5 mm PITCH	45	150
M10 1.5 mm PITCH	50	75
M10 1.5 mm PITCH	55	75
M10 1.5 mm PITCH	60	75
M10 1.5 mm PITCH	65	75
M10 1.5 mm PITCH	70	75
M10 1.5 mm PITCH	75	75
M10 1.5 mm PITCH	80	75
M10 1.5 mm PITCH	90	50
M10 1.5 mm PITCH	100	50
M10 1.5 mm PITCH	110	50
M10 1.5 mm PITCH	120	50
M10 1.5 mm PITCH	130	50
M10 1.5 mm PITCH	140	50
M10 1.5 mm PITCH	150	50

HEXAGON HEAD M12 1.75mm Pitch



BOLTS & NUTS

METRIC 4.6 AS1111 – 2000 / AS1112 – 2000

PLAIN FINISH

DIAMETER mm	LENGTH mm	STANDARD PACK
M12 1.75 mm PITCH	25	200
M12 1.75 mm PITCH	30	200
M12 1.75 mm PITCH	35	200
M12 1.75 mm PITCH	40	200
M12 1.75 mm PITCH	45	200
M12 1.75 mm PITCH	50	150
M12 1.75 mm PITCH	55	150
M12 1.75 mm PITCH	60	150
M12 1.75 mm PITCH	65	150
M12 1.75 mm PITCH	70	150
M12 1.75 mm PITCH	75	150
M12 1.75 mm PITCH	80	150
M12 1.75 mm PITCH	85	100
M12 1.75 mm PITCH	90	100
M12 1.75 mm PITCH	100	100
M12 1.75 mm PITCH	110	100
M12 1.75 mm PITCH	120	100
M12 1.75 mm PITCH	130	75
M12 1.75 mm PITCH	140	75
M12 1.75 mm PITCH	150	75
M12 1.75 mm PITCH	160	75
M12 1.75 mm PITCH	170	75
M12 1.75 mm PITCH	180	50
M12 1.75 mm PITCH	200	50
M12 1.75 mm PITCH	220	50
M12 1.75 mm PITCH	240	50
M12 1.75 mm PITCH	260	50
M12 1.75 mm PITCH	280	50
M12 1.75 mm PITCH	300	50

HEXAGON HEAD M12 1.75mm Pitch**BOLTS & NUTS**

METRIC 4.6 AS1111 – 2000 / AS1112 – 2000

GALVANISED

DIAMETER mm	LENGTH mm	STANDARD PACK
M12 1.75 mm PITCH	25	200
M12 1.75 mm PITCH	30	200
M12 1.75 mm PITCH	35	200
M12 1.75 mm PITCH	40	200
M12 1.75 mm PITCH	45	200
M12 1.75 mm PITCH	50	150
M12 1.75 mm PITCH	55	150
M12 1.75 mm PITCH	60	150
M12 1.75 mm PITCH	65	150
M12 1.75 mm PITCH	70	150
M12 1.75 mm PITCH	75	150
M12 1.75 mm PITCH	80	150
M12 1.75 mm PITCH	85	100
M12 1.75 mm PITCH	90	100
M12 1.75 mm PITCH	100	100
M12 1.75 mm PITCH	110	100
M12 1.75 mm PITCH	120	100
M12 1.75 mm PITCH	130	75
M12 1.75 mm PITCH	140	75
M12 1.75 mm PITCH	150	75
M12 1.75 mm PITCH	160	75
M12 1.75 mm PITCH	170	75
M12 1.75 mm PITCH	180	50
M12 1.75 mm PITCH	200	50
M12 1.75 mm PITCH	220	50
M12 1.75 mm PITCH	240	50
M12 1.75 mm PITCH	260	50
M12 1.75 mm PITCH	280	50
M12 1.75 mm PITCH	300	50
M12 1.75 mm PITCH	325	50
M12 1.75 mm PITCH	350	50
M12 1.75 mm PITCH	375	50
M12 1.75 mm PITCH	400	50

HEXAGON HEAD M12 1.75mm Pitch



BOLTS & NUTS

METRIC 4.6 AS1111 – 2000 / AS1112 – 2000
GALVANISED

DIAMETER mm	LENGTH mm	STANDARD PACK
M12 1.75 mm PITCH	425	25
M12 1.75 mm PITCH	450	25
M12 1.75 mm PITCH	500	25
M12 1.75 mm PITCH	550	25
M12 1.75 mm PITCH	600	25

HEXAGON HEAD M12 1.75mm Pitch**BOLTS & NUTS**

METRIC 4.6 AS1111 – 2000 / AS1112 – 2000

ZINC PLATED

DIAMETER mm	LENGTH mm	STANDARD PACK
M12 1.75 mm PITCH	25	200
M12 1.75 mm PITCH	30	200
M12 1.75 mm PITCH	35	200
M12 1.75 mm PITCH	40	200
M12 1.75 mm PITCH	45	200
M12 1.75 mm PITCH	50	150
M12 1.75 mm PITCH	55	150
M12 1.75 mm PITCH	60	150
M12 1.75 mm PITCH	65	150
M12 1.75 mm PITCH	70	150
M12 1.75 mm PITCH	75	150
M12 1.75 mm PITCH	80	150
M12 1.75 mm PITCH	85	100
M12 1.75 mm PITCH	90	100
M12 1.75 mm PITCH	100	100
M12 1.75 mm PITCH	110	100
M12 1.75 mm PITCH	120	100
M12 1.75 mm PITCH	130	75
M12 1.75 mm PITCH	140	75
M12 1.75 mm PITCH	150	75

HEXAGON HEAD M16 2.0mm Pitch**BOLTS & NUTS**

METRIC 4.6 AS1111 – 2000 / AS1112 – 2000

PLAIN FINISH

DIAMETER mm	LENGTH mm	STANDARD PACK
M16 2.0 mm PITCH	25	100
M16 2.0 mm PITCH	30	100
M16 2.0 mm PITCH	35	100
M16 2.0 mm PITCH	40	100
M16 2.0 mm PITCH	45	100
M16 2.0 mm PITCH	50	100
M16 2.0 mm PITCH	55	75
M16 2.0 mm PITCH	60	75
M16 2.0 mm PITCH	65	75
M16 2.0 mm PITCH	70	50
M16 2.0 mm PITCH	75	50
M16 2.0 mm PITCH	80	50
M16 2.0 mm PITCH	85	50
M16 2.0 mm PITCH	90	50
M16 2.0 mm PITCH	100	50
M16 2.0 mm PITCH	110	50
M16 2.0 mm PITCH	120	50
M16 2.0 mm PITCH	130	50
M16 2.0 mm PITCH	140	50
M16 2.0 mm PITCH	150	50
M16 2.0 mm PITCH	160	50
M16 2.0 mm PITCH	170	30
M16 2.0 mm PITCH	180	30
M16 2.0 mm PITCH	200	30
M16 2.0 mm PITCH	220	30
M16 2.0 mm PITCH	240	30
M16 2.0 mm PITCH	260	25
M16 2.0 mm PITCH	280	25
M16 2.0 mm PITCH	300	25

HEXAGON HEAD M16 2.0mm Pitch**BOLTS & NUTS**

METRIC 4.6 AS1111 – 2000 / AS1112 – 2000

GALVANISED

DIAMETER mm	LENGTH mm	STANDARD PACK
M16 2.0 mm PITCH	25	100
M16 2.0 mm PITCH	30	100
M16 2.0 mm PITCH	35	100
M16 2.0 mm PITCH	40	100
M16 2.0 mm PITCH	45	100
M16 2.0 mm PITCH	50	100
M16 2.0 mm PITCH	55	75
M16 2.0 mm PITCH	60	75
M16 2.0 mm PITCH	65	75
M16 2.0 mm PITCH	70	50
M16 2.0 mm PITCH	75	50
M16 2.0 mm PITCH	80	50
M16 2.0 mm PITCH	85	50
M16 2.0 mm PITCH	90	50
M16 2.0 mm PITCH	100	50
M16 2.0 mm PITCH	110	50
M16 2.0 mm PITCH	120	50
M16 2.0 mm PITCH	130	50
M16 2.0 mm PITCH	140	50
M16 2.0 mm PITCH	150	50
M16 2.0 mm PITCH	160	50
M16 2.0 mm PITCH	170	30
M16 2.0 mm PITCH	180	30
M16 2.0 mm PITCH	200	30
M16 2.0 mm PITCH	220	30
M16 2.0 mm PITCH	240	30
M16 2.0 mm PITCH	260	25
M16 2.0 mm PITCH	280	25
M16 2.0 mm PITCH	300	25
M16 2.0 mm PITCH	325	25
M16 2.0 mm PITCH	350	25
M16 2.0 mm PITCH	375	25
M16 2.0 mm PITCH	400	25

HEXAGON HEAD M16 2.0mm Pitch**BOLTS & NUTS**

METRIC 4.6 AS1111 – 2000 / AS1112 – 2000

GALVANISED

DIAMETER mm	LENGTH mm	STANDARD PACK
M16 2.0 mm PITCH	425	25
M16 2.0 mm PITCH	450	25
M16 2.0 mm PITCH	475	25
M16 2.0 mm PITCH	500	25
M16 2.0 mm PITCH	550	15
M16 2.0 mm PITCH	600	15

HEXAGON HEAD M16 2.0mm Pitch**BOLTS & NUTS**

METRIC 4.6 AS1111 – 2000 / AS1112 – 2000 ZINC PLATED

DIAMETER mm	LENGTH mm	STANDARD PACK
M16 2.0 mm PITCH	25	100
M16 2.0 mm PITCH	30	100
M16 2.0 mm PITCH	35	100
M16 2.0 mm PITCH	40	100
M16 2.0 mm PITCH	45	100
M16 2.0 mm PITCH	50	100
M16 2.0 mm PITCH	55	75
M16 2.0 mm PITCH	60	75
M16 2.0 mm PITCH	65	75
M16 2.0 mm PITCH	70	50
M16 2.0 mm PITCH	75	50
M16 2.0 mm PITCH	80	50
M16 2.0 mm PITCH	85	50
M16 2.0 mm PITCH	90	50

HEXAGON HEAD M16 2.0mm Pitch**BOLTS & NUTS**

METRIC 4.6 AS1111 – 2000 / AS1112 – 2000 ZINC PLATED

DIAMETER mm	LENGTH mm	STANDARD PACK
M16 2.0 mm PITCH	100	50
M16 2.0 mm PITCH	110	50
M16 2.0 mm PITCH	120	50
M16 2.0 mm PITCH	130	50
M16 2.0 mm PITCH	140	50
M16 2.0 mm PITCH	150	50

HEXAGON HEAD M20 2.5mm Pitch**BOLTS & NUTS**

METRIC 4.6 AS1111 – 2000 / AS1112 – 2000 ZINC PLATED

DIAMETER mm	LENGTH mm	STANDARD PACK
M20 2.5 mm PITCH	35	50
M20 2.5 mm PITCH	40	50
M20 2.5 mm PITCH	45	50
M20 2.5 mm PITCH	50	50
M20 2.5 mm PITCH	55	50
M20 2.5 mm PITCH	60	50
M20 2.5 mm PITCH	65	50
M20 2.5 mm PITCH	70	50
M20 2.5 mm PITCH	75	50
M20 2.5 mm PITCH	80	50
M20 2.5 mm PITCH	85	30
M20 2.5 mm PITCH	90	30
M20 2.5 mm PITCH	100	30
M20 2.5 mm PITCH	110	30
M20 2.5 mm PITCH	120	30
M20 2.5 mm PITCH	130	30

HEXAGON HEAD M20 2.5mm Pitch



BOLTS & NUTS

METRIC 4.6 AS1111 – 2000 / AS1112 – 2000 ZINC PLATED

DIAMETER mm	LENGTH mm	STANDARD PACK
M20 2.5 mm PITCH	140	25
M20 2.5 mm PITCH	150	25
M20 2.5 mm PITCH	160	25
M20 2.5 mm PITCH	170	25
M20 2.5 mm PITCH	180	25
M20 2.5 mm PITCH	190	25
M20 2.5 mm PITCH	200	20
M20 2.5 mm PITCH	220	20
M20 2.5 mm PITCH	240	15
M20 2.5 mm PITCH	260	15
M20 2.5 mm PITCH	280	15
M20 2.5 mm PITCH	300	15

HEXAGON HEAD M20 2.5mm Pitch



BOLTS & NUTS

METRIC 4.6 AS1111 – 2000 / AS1112 – 2000 GALVANISED

DIAMETER mm	LENGTH mm	STANDARD PACK
M20 2.5 mm PITCH	35	50
M20 2.5 mm PITCH	40	50
M20 2.5 mm PITCH	45	50
M20 2.5 mm PITCH	50	50
M20 2.5 mm PITCH	55	50
M20 2.5 mm PITCH	60	50
M20 2.5 mm PITCH	65	50
M20 2.5 mm PITCH	70	50
M20 2.5 mm PITCH	75	50
M20 2.5 mm PITCH	80	50

HEXAGON HEAD M20 2.5mm Pitch**BOLTS & NUTS****METRIC 4.6 AS1111 – 2000 / AS1112 – 2000 GALVANISED**

DIAMETER mm	LENGTH mm	STANDARD PACK
M20 2.5 mm PITCH	85	30
M20 2.5 mm PITCH	90	30
M20 2.5 mm PITCH	100	30
M20 2.5 mm PITCH	110	30
M20 2.5 mm PITCH	120	30
M20 2.5 mm PITCH	130	30
M20 2.5 mm PITCH	140	25
M20 2.5 mm PITCH	150	25
M20 2.5 mm PITCH	160	25
M20 2.5 mm PITCH	170	25
M20 2.5 mm PITCH	180	25
M20 2.5 mm PITCH	190	25
M20 2.5 mm PITCH	200	20
M20 2.5 mm PITCH	220	20
M20 2.5 mm PITCH	240	15
M20 2.5 mm PITCH	260	15
M20 2.5 mm PITCH	280	15
M20 2.5 mm PITCH	300	15
M20 2.5 mm PITCH	325	25
M20 2.5 mm PITCH	350	25
M20 2.5 mm PITCH	375	10
M20 2.5 mm PITCH	400	10
M20 2.5 mm PITCH	425	10
M20 2.5 mm PITCH	450	10
M20 2.5 mm PITCH	475	10
M20 2.5 mm PITCH	500	10
M20 2.5 mm PITCH	525	10
M20 2.5 mm PITCH	550	10
M20 2.5 mm PITCH	575	10
M20 2.5 mm PITCH	600	10
M20 2.5 mm PITCH	650	10
M20 2.5 mm PITCH	700	8
M20 2.5 mm PITCH	750	8
M20 2.5 mm PITCH	800	8

HEXAGON HEAD M20 2.5mm Pitch**BOLTS & NUTS**

METRIC 4.6 AS1111 – 2000 / AS1112 – 2000

ZINC PLATED

DIAMETER mm	LENGTH mm	STANDARD PACK
M20 2.5 mm PITCH	35	50
M20 2.5 mm PITCH	40	50
M20 2.5 mm PITCH	45	50
M20 2.5 mm PITCH	50	50
M20 2.5 mm PITCH	55	50
M20 2.5 mm PITCH	60	50
M20 2.5 mm PITCH	65	50
M20 2.5 mm PITCH	70	50
M20 2.5 mm PITCH	75	50
M20 2.5 mm PITCH	80	50
M20 2.5 mm PITCH	85	30
M20 2.5 mm PITCH	90	30
M20 2.5 mm PITCH	100	30
M20 2.5 mm PITCH	110	30
M20 2.5 mm PITCH	120	30
M20 2.5 mm PITCH	130	30
M20 2.5 mm PITCH	140	25
M20 2.5 mm PITCH	150	25

HEXAGON HEAD M24 3.0mm Pitch**BOLTS & NUTS**

METRIC 4.6 AS1111 – 2000 / AS1112 – 2000

PLAIN FINISH

DIAMETER mm	LENGTH mm	STANDARD PACK
M24 3.0 mm PITCH	50	25
M24 3.0 mm PITCH	55	25
M24 3.0 mm PITCH	60	25
M24 3.0 mm PITCH	65	25
M24 3.0 mm PITCH	70	25
M24 3.0 mm PITCH	75	25
M24 3.0 mm PITCH	80	25
M24 3.0 mm PITCH	85	25
M24 3.0 mm PITCH	90	25
M24 3.0 mm PITCH	100	20
M24 3.0 mm PITCH	110	20
M24 3.0 mm PITCH	120	20
M24 3.0 mm PITCH	130	20
M24 3.0 mm PITCH	140	20
M24 3.0 mm PITCH	150	15
M24 3.0 mm PITCH	160	15
M24 3.0 mm PITCH	170	15
M24 3.0 mm PITCH	180	15
M24 3.0 mm PITCH	190	15
M24 3.0 mm PITCH	200	15
M24 3.0 mm PITCH	220	15
M24 3.0 mm PITCH	240	10
M24 3.0 mm PITCH	260	10
M24 3.0 mm PITCH	280	10
M24 3.0 mm PITCH	300	10

HEXAGON HEAD M24 3.0mm Pitch



BOLTS & NUTS

METRIC 4.6 AS1111 – 2000 / AS1112 – 2000

GALVANISED

DIAMETER mm	LENGTH mm	STANDARD PACK
M24 3.0 mm PITCH	50	25
M24 3.0 mm PITCH	55	25
M24 3.0 mm PITCH	60	25
M24 3.0 mm PITCH	65	25
M24 3.0 mm PITCH	70	25
M24 3.0 mm PITCH	75	25
M24 3.0 mm PITCH	80	25
M24 3.0 mm PITCH	85	25
M24 3.0 mm PITCH	90	25
M24 3.0 mm PITCH	100	20
M24 3.0 mm PITCH	110	20
M24 3.0 mm PITCH	120	20
M24 3.0 mm PITCH	130	20
M24 3.0 mm PITCH	140	20
M24 3.0 mm PITCH	150	15
M24 3.0 mm PITCH	160	15
M24 3.0 mm PITCH	170	15
M24 3.0 mm PITCH	180	15
M24 3.0 mm PITCH	190	15
M24 3.0 mm PITCH	200	15
M24 3.0 mm PITCH	220	15
M24 3.0 mm PITCH	240	10
M24 3.0 mm PITCH	260	10
M24 3.0 mm PITCH	280	10
M24 3.0 mm PITCH	300	10
M24 3.0 mm PITCH	325	10
M24 3.0 mm PITCH	350	10
M24 3.0 mm PITCH	375	10
M24 3.0 mm PITCH	400	10
M24 3.0 mm PITCH	425	10
M24 3.0 mm PITCH	450	10

HEXAGON HEAD M24 3.0mm Pitch



BOLTS & NUTS

METRIC 4.6 AS1111 – 2000 / AS1112 – 2000
 GALVANISED

DIAMETER mm	LENGTH mm	STANDARD PACK
M24 3.0 mm PITCH	475	5
M24 3.0 mm PITCH	500	5
M24 3.0 mm PITCH	525	5
M24 3.0 mm PITCH	550	5
M24 3.0 mm PITCH	575	5
M24 3.0 mm PITCH	600	5
M24 3.0 mm PITCH	650	4
M24 3.0 mm PITCH	700	4
M24 3.0 mm PITCH	750	4
M24 3.0 mm PITCH	800	4

HEXAGON HEAD M30 3.5mm Pitch



BOLTS & NUTS

METRIC 4.6 AS1111 – 2000 / AS1112 – 2000 PLAIN FINISH

DIAMETER mm	LENGTH mm	STANDARD PACK
M30 3.5 mm PITCH	75	10
M30 3.5 mm PITCH	90	10
M30 3.5 mm PITCH	100	10
M30 3.5 mm PITCH	110	10
M30 3.5 mm PITCH	120	10
M30 3.5 mm PITCH	130	10
M30 3.5 mm PITCH	140	10

M30 3.5 mm PITCH	150	5
M30 3.5 mm PITCH	180	5
M30 3.5 mm PITCH	200	5
M30 3.5 mm PITCH	220	5
M30 3.5 mm PITCH	240	5
M30 3.5 mm PITCH	260	5
M30 3.5 mm PITCH	280	5
M30 3.5 mm PITCH	300	5

HEXAGON HEAD M30 3.5mm Pitch



BOLTS & NUTS

METRIC 4.6 AS1111 – 2000 / AS1112 – 2000

GALVANISED

DIAMETER mm	LENGTH mm	STANDARD PACK
M30 3.5 mm PITCH	75	10
M30 3.5 mm PITCH	90	10
M30 3.5 mm PITCH	100	10
M30 3.5 mm PITCH	110	10
M30 3.5 mm PITCH	120	10
M30 3.5 mm PITCH	130	10
M30 3.5 mm PITCH	140	10
M30 3.5 mm PITCH	150	5
M30 3.5 mm PITCH	180	5
M30 3.5 mm PITCH	200	5
M30 3.5 mm PITCH	220	5
M30 3.5 mm PITCH	240	5
M30 3.5 mm PITCH	260	5
M30 3.5 mm PITCH	280	5
M30 3.5 mm PITCH	300	5
M30 3.5 mm PITCH	350	4
M30 3.5 mm PITCH	350	4
M30 3.5 mm PITCH	400	4
M30 3.5 mm PITCH	450	4
M30 3.5 mm PITCH	500	4
M30 3.5 mm PITCH	550	4
M30 3.5 mm PITCH	600	4
M30 3.5 mm PITCH	700	2
M30 3.5 mm PITCH	800	2

HEXAGON HEAD M36 4.0mm Pitch



BOLTS & NUTS

METRIC 4.6 AS1111 – 2000 / AS1112 – 2000

PLAIN FINISH

DIAMETER mm	LENGTH mm	STANDARD PACK
M36 4.0 mm PITCH	100	5
M36 4.0 mm PITCH	130	5
M36 4.0 mm PITCH	150	5
M36 4.0 mm PITCH	170	5
M36 4.0 mm PITCH	200	5
M36 4.0 mm PITCH	220	5
M36 4.0 mm PITCH	240	5
M36 4.0 mm PITCH	260	5
M36 4.0 mm PITCH	280	5
M36 4.0 mm PITCH	300	5

HEXAGON HEAD M36 4.0mm Pitch



BOLTS & NUTS

METRIC 4.6 AS1111 – 2000 / AS1112 – 2000

GALVANISED

DIAMETER mm	LENGTH mm	STANDARD PACK
M36 4.0 mm PITCH	100	5
M36 4.0 mm PITCH	130	5
M36 4.0 mm PITCH	150	5
M36 4.0 mm PITCH	170	5
M36 4.0 mm PITCH	200	5

M36 4.0 mm PITCH	220	5
M36 4.0 mm PITCH	240	5
M36 4.0 mm PITCH	260	5
M36 4.0 mm PITCH	280	5
M36 4.0 mm PITCH	300	5
M36 4.0 mm PITCH	400	2
M36 4.0 mm PITCH	500	2
M36 4.0 mm PITCH	600	2
M36 4.0 mm PITCH	700	2
M36 4.0 mm PITCH	800	2

HEXAGON HEAD M6 1.0mm Pitch



SET SCREWS

METRIC 4.6 AS1111 – 2000 / AS1112 – 2000
 ZINC PLATED

DIAMETER mm	LENGTH mm	STANDARD PACK
M6 1.0 mm PITCH	10	200
M6 1.0 mm PITCH	12	200
M6 1.0 mm PITCH	16	200
M6 1.0 mm PITCH	20	200
M6 1.0 mm PITCH	25	200
M6 1.0 mm PITCH	30	200
M6 1.0 mm PITCH	40	200
M6 1.0 mm PITCH	50	200
M6 1.0 mm PITCH	65	200
M6 1.0 mm PITCH	70	200

HEXAGON HEAD M8 1.25mm Pitch



SET SCREWS

METRIC 4.6 AS1111 – 2000 / AS1112 – 2000

ZINC PLATED

DIAMETER mm	LENGTH mm	STANDARD PACK
M8 1.25 mm PITCH	12	200
M8 1.25 mm PITCH	16	200
M8 1.25 mm PITCH	20	200
M8 1.25 mm PITCH	25	200
M8 1.25 mm PITCH	30	200
M8 1.25 mm PITCH	35	200
M8 1.25 mm PITCH	40	200
M8 1.25 mm PITCH	50	200
M8 1.25 mm PITCH	65	150
M8 1.25 mm PITCH	75	150
M8 1.25 mm PITCH	100	150

HEXAGON HEAD M10 1.5mm Pitch



SET SCREWS

METRIC 4.6 AS1111 – 2000 ZINC PLATED

DIAMETER mm	LENGTH mm	STANDARD PACK
M10 1.5 mm PITCH	16	150
M10 1.5 mm PITCH	20	150
M10 1.5 mm PITCH	25	150
M10 1.5 mm PITCH	30	150
M10 1.5 mm PITCH	35	150
M10 1.5 mm PITCH	40	150
M10 1.5 mm PITCH	50	75
M10 1.5 mm PITCH	65	75
M10 1.5 mm PITCH	75	75
M10 1.5 mm PITCH	90	50
M10 1.5 mm PITCH	100	50

HEXAGON HEAD M12 1.75mm Pitch



SET SCREWS

METRIC 4.6 AS1111 – 2000

ZINC PLATED

DIAMETER mm	LENGTH mm	STANDARD PACK
M12 1.75 mm PITCH	20	100
M12 1.75 mm PITCH	25	100
M12 1.75 mm PITCH	30	100
M12 1.75 mm PITCH	35	100
M12 1.75 mm PITCH	40	100
M12 1.75 mm PITCH	50	75
M12 1.75 mm PITCH	60	75
M12 1.75 mm PITCH	75	75
M12 1.75 mm PITCH	90	50
M12 1.75 mm PITCH	100	50

M12 1.75 mm PITCH	110	50
M12 1.75 mm PITCH	130	50
M12 1.75 mm PITCH	150	50

HEXAGON HEAD M16 2.5mm Pitch



SET SCREWS

METRIC 4.6 AS1111 – 2000
 ZINC PLATED

DIAMETER mm	LENGTH mm	STANDARD PACK
M16 2.5 mm PITCH	30	50
M16 2.5 mm PITCH	40	50
M16 2.5 mm PITCH	50	50
M16 2.5 mm PITCH	60	50
M16 2.5 mm PITCH	75	25
M16 2.5 mm PITCH	90	25
M16 2.5 mm PITCH	100	25
M16 2.5 mm PITCH	110	25
M16 2.5 mm PITCH	130	25
M16 2.5 mm PITCH	150	25

HEXAGON HEAD M20 2.5mm Pitch



SET SCREWS

METRIC 4.6 AS1111 – 2000

ZINC PLATED

DIAMETER mm	LENGTH mm	STANDARD PACK
----------------	--------------	------------------

M20 2.5 mm PITCH	40	25
M20 2.5 mm PITCH	50	25
M20 2.5 mm PITCH	60	20
M20 2.5 mm PITCH	75	20
M20 2.5 mm PITCH	100	20
M20 2.5 mm PITCH	130	10
M20 2.5 mm PITCH	150	10

CUP HEAD BSW ¼ 20 TPI



BOLTS & NUTS

AS B108 – 1952 / AS 2451 - 1998

ZINC PLATED

DIAMETER Inches	LENGTH Inches	STANDARD PACK
--------------------	------------------	------------------

¼ 20 TPI	¾	150
¼ 20 TPI	1	150
¼ 20 TPI	1. ¼	150
¼ 20 TPI	1. ½	150
¼ 20 TPI	1. ¾	150
¼ 20 TPI	2	150
¼ 20 TPI	2. ½	150
¼ 20 TPI	3	150
¼ 20 TPI	3. ½	150
¼ 20 TPI	4	150
¼ 20 TPI	4. ½	100
¼ 20 TPI	5	100
¼ 20 TPI	5. ½	100
¼ 20 TPI	6	100

CUP HEAD BSW 5/16 18 TPI**BOLTS & NUTS**

AS B108 – 1952 / AS 2451 - 1998

ZINC PLATED

DIAMETER Inches	LENGTH Inches	STANDARD PACK
5/16 18 TPI	$\frac{3}{4}$	150
5/16 18 TPI	1	150
5/16 18 TPI	1. $\frac{1}{4}$	150
5/16 18 TPI	1. $\frac{1}{2}$	150
5/16 18 TPI	1. $\frac{3}{4}$	150
5/16 18 TPI	2	150
5/16 18 TPI	2. $\frac{1}{2}$	150

CUP HEAD BSW 5/16 18 TPI**BOLTS & NUTS**

AS B108 – 1952 / AS 2451 - 1998

ZINC PLATED

DIAMETER Inches	LENGTH Inches	STANDARD PACK
5/16 18 TPI	3	100
5/16 18 TPI	3. $\frac{1}{2}$	100
5/16 18 TPI	4	100
5/16 18 TPI	4. $\frac{1}{2}$	100
5/16 18 TPI	5	100
5/16 18 TPI	5. $\frac{1}{2}$	100
5/16 18 TPI	6	100
5/16 18 TPI	7	100

CUP HEAD BSW 3/8 16 TPI**BOLTS & NUTS**

AS B108 – 1952 / AS 2451 - 1998

ZINC PLATED

DIAMETER Inches	LENGTH Inches	STANDARD PACK
3/8 16 TPI	$\frac{3}{4}$	150
3/8 16 TPI	1	150
3/8 16 TPI	1. $\frac{1}{2}$	150
3/8 16 TPI	2	100
3/8 16 TPI	2. $\frac{1}{2}$	100
3/8 16 TPI	3	100
3/8 16 TPI	3. $\frac{1}{2}$	50
3/8 16 TPI	4	50
3/8 16 TPI	4. $\frac{1}{2}$	50
3/8 16 TPI	5	50
3/8 16 TPI	5. $\frac{1}{2}$	50
3/8 16 TPI	6	50
3/8 16 TPI	6. $\frac{1}{2}$	50
3/8 16 TPI	7	50
3/8 16 TPI	8	25
3/8 16 TPI	9	25
3/8 16 TPI	10	25
3/8 16 TPI	11	25
3/8 16 TPI	12	25

CUP HEAD BSW ½ 12 TPI**BOLTS & NUTS**

AS B108 – 1952 / AS 2451 - 1998

ZINC PLATED

DIAMETER Inches	LENGTH Inches	STANDARD PACK
½ 12 TPI	1. ½	25
½ 12 TPI	2	25
½ 12 TPI	2. ½	25
½ 12 TPI	3	25
½ 12 TPI	3. ½	25
½ 12 TPI	4	25
½ 12 TPI	4. ½	25
½ 12 TPI	5	25
½ 12 TPI	5. ½	25
½ 12 TPI	6	25
½ 12 TPI	6. ½	25
½ 12 TPI	7	25
½ 12 TPI	8	25
½ 12 TPI	9	25
½ 12 TPI	10	25
½ 12 TPI	11	25
½ 12 TPI	12	25

CUP HEAD METRIC M6 1.0 mm PITCH**BOLTS & NUTS**

AS 1390 - 1997 / AS 1112 - 2000 GALVANISED

DIAMETER mm	LENGTH mm	STANDARD PACK
M6 1.0 mm PITCH	20	200
M6 1.0 mm PITCH	25	200
M6 1.0 mm PITCH	30	200
M6 1.0 mm PITCH	40	200
M6 1.0 mm PITCH	45	200
M6 1.0 mm PITCH	50	200
M6 1.0 mm PITCH	60	150
M6 1.0 mm PITCH	65	150
M6 1.0 mm PITCH	70	150
M6 1.0 mm PITCH	75	150
M6 1.0 mm PITCH	90	150
M6 1.0 mm PITCH	100	150

CUP HEAD METRIC M6 1.0 mm PITCH**BOLTS & NUTS**

AS 1390 - 1997 / AS 1112 - 2000

ZINC PLATED

DIAMETER mm	LENGTH mm	STANDARD PACK
M6 1.0 mm PITCH	20	200
M6 1.0 mm PITCH	25	200
M6 1.0 mm PITCH	30	200
M6 1.0 mm PITCH	40	200
M6 1.0 mm PITCH	45	200
M6 1.0 mm PITCH	50	200

M6 1.0 mm PITCH	60	150
M6 1.0 mm PITCH	65	150
M6 1.0 mm PITCH	70	150
M6 1.0 mm PITCH	75	150
M6 1.0 mm PITCH	90	150
M6 1.0 mm PITCH	100	150
M6 1.0 mm PITCH	110	100

CUP HEAD METRIC M8 1.25 mm PITCH



BOLTS & NUTS

AS 1390 - 1997 / AS 1112 - 2000

GALVANISED

DIAMETER mm	LENGTH mm	STANDARD PACK
M8 1.25 mm PITCH	20	200
M8 1.25 mm PITCH	25	200
M8 1.25 mm PITCH	30	200
M8 1.25 mm PITCH	40	200
M8 1.25 mm PITCH	45	150
M8 1.25 mm PITCH	50	150
M8 1.25 mm PITCH	60	150
M8 1.25 mm PITCH	65	150
M8 1.25 mm PITCH	70	100
M8 1.25 mm PITCH	75	100
M8 1.25 mm PITCH	90	100
M8 1.25 mm PITCH	100	100
M8 1.25 mm PITCH	110	100
M8 1.25 mm PITCH	120	100
M8 1.25 mm PITCH	130	100
M8 1.25 mm PITCH	140	100
M8 1.25 mm PITCH	150	100
M8 1.25 mm PITCH	180	50

CUP HEAD METRIC M8 1.25 mm PITCH



BOLTS & NUTS

AS 1390 - 1997 / AS 1112 - 2000

ZINC PLATED

DIAMETER mm	LENGTH mm	STANDARD PACK
M8 1.25 mm PITCH	20	200
M8 1.25 mm PITCH	25	200
M8 1.25 mm PITCH	30	200
M8 1.25 mm PITCH	40	200
M8 1.25 mm PITCH	45	150
M8 1.25 mm PITCH	50	150
M8 1.25 mm PITCH	60	150
M8 1.25 mm PITCH	65	150
M8 1.25 mm PITCH	70	100

CUP HEAD METRIC M8 1.25 mm PITCH



BOLTS & NUTS

AS 1390 - 1997 / AS 1112 - 2000

ZINC PLATED

DIAMETER mm	LENGTH mm	STANDARD PACK
M8 1.25 mm PITCH	75	100
M8 1.25 mm PITCH	90	100
M8 1.25 mm PITCH	100	100
M8 1.25 mm PITCH	110	100
M8 1.25 mm PITCH	120	100
M8 1.25 mm PITCH	130	100
M8 1.25 mm PITCH	140	100

CUP HEAD METRIC M10 1.5 mm PITCH**BOLTS & NUTS**

AS 1390 - 1997 / AS 1112 - 2000

GALVANISED

DIAMETER mm	LENGTH mm	STANDARD PACK
M10 1.5 mm PITCH	25	200
M10 1.5 mm PITCH	30	200
M10 1.5 mm PITCH	40	150
10 1.5 mm PITCH	45	150
M10 1.5 mm PITCH	50	100
M10 1.5 mm PITCH	60	100
M10 1.5 mm PITCH	65	100
M10 1.5 mm PITCH	70	100
M10 1.5 mm PITCH	75	100
M10 1.5 mm PITCH	85	100
M10 1.5 mm PITCH	90	50
M10 1.5 mm PITCH	100	50
M10 1.5 mm PITCH	110	50
M10 1.5 mm PITCH	120	50
M10 1.5 mm PITCH	130	50
M10 1.5 mm PITCH	140	50
M10 1.5 mm PITCH	150	50

CUP HEAD METRIC M10 1.5 mm PITCH**BOLTS & NUTS**

AS 1390 - 1997 / AS 1112 - 2000 GALVANISED

DIAMETER mm	LENGTH mm	STANDARD PACK
M10 1.5 mm PITCH	160	100
M10 1.5 mm PITCH	170	100
M10 1.5 mm PITCH	180	100
M10 1.5 mm PITCH	190	100
M10 1.5 mm PITCH	200	100
M10 1.5 mm PITCH	220	100
M10 1.5 mm PITCH	240	75
M10 1.5 mm PITCH	260	75
M10 1.5 mm PITCH	280	75
M10 1.5 mm PITCH	300	75
M10 1.5 mm PITCH	325	75
M10 1.5 mm PITCH	350	75
M10 1.5 mm PITCH	375	75
M10 1.5 mm PITCH	400	75

CUP HEAD METRIC M10 1.5 mm PITCH**BOLTS & NUTS**

AS 1390 - 1997 / AS 1112 - 2000 ZINC PLATED

DIAMETER mm	LENGTH mm	STANDARD PACK
M10 1.5 mm PITCH	20	200
M10 1.5 mm PITCH	25	200
M10 1.5 mm PITCH	30	200
M10 1.5 mm PITCH	40	150
M10 1.5 mm PITCH	45	150
M10 1.5 mm PITCH	50	100
M10 1.5 mm PITCH	60	100
M10 1.5 mm PITCH	65	100

CUP HEAD METRIC M10 1.5 mm PITCH



BOLTS & NUTS

AS 1390 - 1997 / AS 1112 – 2000 ZINC PLATED

DIAMETER mm	LENGTH mm	STANDARD PACK
M10 1.5 mm PITCH	70	100
M10 1.5 mm PITCH	75	100
M10 1.5 mm PITCH	85	100
M10 1.5 mm PITCH	90	50
M10 1.5 mm PITCH	100	50
M10 1.5 mm PITCH	110	50
M10 1.5 mm PITCH	120	50
M10 1.5 mm PITCH	130	50
M10 1.5 mm PITCH	140	50
M10 1.5 mm PITCH	150	50
M10 1.5 mm PITCH	170	100
M10 1.5 mm PITCH	180	100
M10 1.5 mm PITCH	190	100
M10 1.5 mm PITCH	200	100

CUP HEAD METRIC M12 1.75mm Pitch



BOLTS & NUTS

AS1390 – 1997 / AS1112 - 2000 GALVANISED

DIAMETER mm	LENGTH mm	STANDARD PACK
M12 1.75 mm PITCH	30	200
M12 1.75 mm PITCH	40	200
M12 1.75 mm PITCH	45	150
M12 1.75 mm PITCH	50	150
M12 1.75 mm PITCH	65	150
M12 1.75 mm PITCH	70	150
M12 1.75 mm PITCH	75	150
M12 1.75 mm PITCH	85	100
M12 1.75 mm PITCH	90	100
M12 1.75 mm PITCH	100	100

CUP HEAD METRIC M12 1.75mm Pitch**BOLTS & NUTS**

AS1390 – 1997 / AS1112 - 2000

GALVANISED

DIAMETER mm	LENGTH mm	STANDARD PACK
M12 1.75 mm PITCH	110	100
M12 1.75 mm PITCH	120	100
M12 1.75 mm PITCH	130	75
M12 1.75 mm PITCH	140	75
M12 1.75 mm PITCH	150	75
M12 1.75 mm PITCH	160	75
M12 1.75 mm PITCH	170	75
M12 1.75 mm PITCH	180	75
M12 1.75 mm PITCH	190	75
M12 1.75 mm PITCH	200	75
M12 1.75 mm PITCH	220	50
M12 1.75 mm PITCH	240	50
M12 1.75 mm PITCH	260	50
M12 1.75 mm PITCH	280	50
M12 1.75 mm PITCH	300	50
M12 1.75 mm PITCH	325	50
M12 1.75 mm PITCH	350	50
M12 1.75 mm PITCH	375	50
M12 1.75 mm PITCH	400	50
M12 1.75 mm PITCH	450	50
M12 1.75 mm PITCH	500	50

CUP HEAD METRIC M12 1.75mm Pitch**BOLTS & NUTS**

AS1390 – 1997 / AS1112 - 2000 ZINC PLATED

DIAMETER mm	LENGTH mm	STANDARD PACK
M12 1.75 mm PITCH	40	200
M12 1.75 mm PITCH	50	150
M12 1.75 mm PITCH	65	150
M12 1.75 mm PITCH	75	150
M12 1.75 mm PITCH	90	100
M12 1.75 mm PITCH	100	100
M12 1.75 mm PITCH	120	100
M12 1.75 mm PITCH	130	75
M12 1.75 mm PITCH	150	75
M12 1.75 mm PITCH	180	75
M12 1.75 mm PITCH	200	75

CUP HEAD METRIC M16 2.0mm Pitch**BOLTS & NUTS**

AS1390 – 1997 / AS1112 - 2000 GALVANISED

DIAMETER mm	LENGTH mm	STANDARD PACK
M16 2.0 mm PITCH	50	100
M16 2.0 mm PITCH	65	75
M16 2.0 mm PITCH	75	75
M16 2.0 mm PITCH	90	50
M16 2.0 mm PITCH	100	50
M16 2.0 mm PITCH	120	50
M16 2.0 mm PITCH	130	50
M16 2.0 mm PITCH	140	50
M16 2.0 mm PITCH	150	50
M16 2.0 mm PITCH	160	50
M16 2.0 mm PITCH	170	30
M16 2.0 mm PITCH	180	30

CUP HEAD METRIC M16 2.0mm Pitch**BOLTS & NUTS**

AS1390 – 1997 / AS1112 - 2000 GALVANISED

DIAMETER mm	LENGTH mm	STANDARD PACK
M16 2.0 mm PITCH	200	30
M16 2.0 mm PITCH	220	30
M16 2.0 mm PITCH	240	30
M16 2.0 mm PITCH	260	25
M16 2.0 mm PITCH	280	25
M16 2.0 mm PITCH	300	25
M16 2.0 mm PITCH	325	25
M16 2.0 mm PITCH	350	25
M16 2.0 mm PITCH	375	25
M16 2.0 mm PITCH	400	25
M16 2.0 mm PITCH	450	25
M16 2.0 mm PITCH	500	25

CUP HEAD METRIC M20 2.5mm Pitch**BOLTS & NUTS**

AS1390 – 1997 / AS1112 - 2000 GALVANISED

DIAMETER mm	LENGTH mm	STANDARD PACK
M20 2.5 mm PITCH	50	50
M20 2.5 mm PITCH	65	50
M20 2.5 mm PITCH	75	50
M20 2.5 mm PITCH	90	30
M20 2.5 mm PITCH	100	50
M20 2.5 mm PITCH	120	30
M20 2.5 mm PITCH	130	30
M20 2.5 mm PITCH	140	30
M20 2.5 mm PITCH	150	30
M20 2.5 mm PITCH	180	30
M20 2.5 mm PITCH	200	30

CUP HEAD METRIC M20 2.5mm Pitch**BOLTS & NUTS**

AS1390 – 1997 / AS1112 - 2000

GALVANISED

DIAMETER mm	LENGTH mm	STANDARD PACK
M20 2.5 mm PITCH	220	25
M20 2.5 mm PITCH	240	25
M20 2.5 mm PITCH	260	20
M20 2.5 mm PITCH	280	20
M20 2.5 mm PITCH	300	20
M20 2.5 mm PITCH	350	10
M20 2.5 mm PITCH	400	10
M20 2.5 mm PITCH	450	10
M20 2.5 mm PITCH	500	10
M20 2.5 mm PITCH	550	10
M20 2.5 mm PITCH	600	10

HEXAGON COACH DIAMETER 6 mm**SCREWS- AS1393 – 1996 GALVANISED**

DIAMETER mm	LENGTH mm	STANDARD PACK
6	25	150
6	30	150
6	40	150
6	50	150
6	65	150
6	75	150
6	100	150

HEXAGON COACH DIAMETER 6 mm**SCREWS- AS1393 – 1996 ZINC PLATED**

DIAMETER mm	LENGTH mm	STANDARD PACK
6	25	150
6	30	150
6	40	150
6	50	150
6	65	150
6	75	150
6	90	150
6	100	150

HEXAGON COACH DIAMETER 8 mm**SCREWS- AS1393 – 1996 GALVANISED**

DIAMETER mm	LENGTH mm	STANDARD PACK
8	30	100
8	40	100
8	50	100
8	65	100
8	75	100
8	90	100
8	100	100

HEXAGON COACH DIAMETER 8 mm**SCREWS- AS1393 – 1996 ZINC PLATED**

DIAMETER mm	LENGTH mm	STANDARD PACK
8	30	150
8	40	150
8	50	150
8	65	150
8	75	150
8	90	150
8	100	150

HEXAGON COACH DIAMETER 10 mm**SCREWS- AS1393 – 1996 GALVANISED**

DIAMETER mm	LENGTH mm	STANDARD PACK
10	40	100
10	50	100
10	65	100
10	75	100
10	90	100
10	100	50
10	120	50
10	130	50
10	150	50

HEXAGON COACH DIAMETER 10 mm**SCREWS- AS1393 – 1996 ZINC PLATED**

DIAMETER mm	LENGTH mm	STANDARD PACK
10	40	100
10	50	100
10	65	100
10	75	100
10	90	100
10	100	100
10	120	100
10	130	100
10	150	100

HEXAGON COACH DIAMETER 12 mm**SCREWS- AS1393 – 1996 GALVANISED**

DIAMETER mm	LENGTH mm	STANDARD PACK
12	40	25
12	50	25
12	65	25
12	75	25
12	90	25
12	100	25
12	120	25
12	130	25
12	150	25
12	180	25
12	200	25

HEXAGON COACH DIAMETER 12 mm**SCREWS- AS1393 – 1996 ZINK PLATED**

DIAMETER mm	LENGTH mm	STANDARD PACK
12	50	50
12	65	50
12	75	50
12	90	50
12	100	50
12	130	50
12	150	50
12	200	50

HEXAGON COACH DIAMETER 16 mm**SCREWS- AS1393 – 1996 GALVANISED**

DIAMETER mm	LENGTH mm	STANDARD PACK
16	50	100
16	75	100
16	100	100
16	130	100
16	150	50
16	200	50

HEXAGON COACH DIAMETER 20 mm**SCREWS- AS1393 – 1996 GALVANISED**

DIAMETER mm	LENGTH mm	STANDARD PACK
20	100	30
20	130	30
20	150	30
20	200	25

BOLT, NUT & WASHER ASSEMBLY**DIAMETER M12 CLASS 8.8 METRIC AS1252 – 1983 GALVANISED**

DIAMETER mm	LENGTH mm	STANDARD PACK
M12 1.75 mm PITCH	30	200
M12 1.75 mm PITCH	35	200
M12 1.75 mm PITCH	40	200
M12 1.75 mm PITCH	45	200
M12 1.75 mm PITCH	50	200
M12 1.75 mm PITCH	55	100
M12 1.75 mm PITCH	60	100
M12 1.75 mm PITCH	65	100
M12 1.75 mm PITCH	70	100
M12 1.75 mm PITCH	75	100
M12 1.75 mm PITCH	80	100
M12 1.75 mm PITCH	85	100
M12 1.75 mm PITCH	90	100
M12 1.75 mm PITCH	100	100
M12 1.75 mm PITCH	110	100
M12 1.75 mm PITCH	120	100
M12 1.75 mm PITCH	130	100
M12 1.75 mm PITCH	140	100
M12 1.75 mm PITCH	150	100
M12 1.75 mm PITCH	160	100
M12 1.75 mm PITCH	170	100
M12 1.75 mm PITCH	180	100
M12 1.75 mm PITCH	190	100
M12 1.75 mm PITCH	200	100
M12 1.75 mm PITCH	250	75
M12 1.75 mm PITCH	300	65

BOLT, NUT & WASHER ASSEMBLY**DIAMETER M16 CLASS 8.8 METRIC AS1252 – 1983 GALVANISED**

DIAMETER mm	LENGTH mm	STANDARD PACK
M16 2.0 mm PITCH	40	100
M16 2.0 mm PITCH	45	100
M16 2.0 mm PITCH	50	100
M16 2.0 mm PITCH	55	100
M16 2.0 mm PITCH	60	100
M16 2.0 mm PITCH	65	75
M16 2.0 mm PITCH	70	75
M16 2.0 mm PITCH	75	75
M16 2.0 mm PITCH	80	75
M16 2.0 mm PITCH	90	75
M16 2.0 mm PITCH	100	75
M16 2.0 mm PITCH	110	60
M16 2.0 mm PITCH	120	60
M16 2.0 mm PITCH	130	60
M16 2.0 mm PITCH	140	50
M16 2.0 mm PITCH	150	50
M16 2.0 mm PITCH	160	40
M16 2.0 mm PITCH	180	40
M16 2.0 mm PITCH	200	40
M16 2.0 mm PITCH	220	30
M16 2.0 mm PITCH	240	30
M16 2.0 mm PITCH	260	30
M16 2.0 mm PITCH	300	30
M16 2.0 mm PITCH	350	30
M16 2.0 mm PITCH	400	30
M16 2.0 mm PITCH	450	30
M16 2.0 mm PITCH	500	20
M16 2.0 mm PITCH	550	20
M16 2.0 mm PITCH	600	20
M16 2.0 mm PITCH	650	20
M16 2.0 mm PITCH	700	20

BOLT, NUT & WASHER ASSEMBLY

**DIAMETER M20 2.5mm PITCH CLASS 8.8 METRIC AS1252 – 1983
GALVANISED**

DIAMETER mm	LENGTH mm	STANDARD PACK
M20 2.5 mm PITCH	40	75
M20 2.5 mm PITCH	45	75
M20 2.5 mm PITCH	50	50
M20 2.5 mm PITCH	55	50
M20 2.5 mm PITCH	60	50
M20 2.5 mm PITCH	65	50
M20 2.5 mm PITCH	70	50
M20 2.5 mm PITCH	75	50
M20 2.5 mm PITCH	80	50
M20 2.5 mm PITCH	85	50
M20 2.5 mm PITCH	90	40
M20 2.5 mm PITCH	100	40
M20 2.5 mm PITCH	110	40
M20 2.5 mm PITCH	120	30
M20 2.5 mm PITCH	130	30
M20 2.5 mm PITCH	140	30
M20 2.5 mm PITCH	150	30
M20 2.5 mm PITCH	160	30
M20 2.5 mm PITCH	180	30
M20 2.5 mm PITCH	200	30
M20 2.5 mm PITCH	220	30
M20 2.5 mm PITCH	240	20
M20 2.5 mm PITCH	260	20
M20 2.5 mm PITCH	280	20
M20 2.5 mm PITCH	300	20
M20 2.5 mm PITCH	350	20
M20 2.5 mm PITCH	400	20
M20 2.5 mm PITCH	450	15
M20 2.5 mm PITCH	500	15
M20 2.5 mm PITCH	550	10
M20 2.5 mm PITCH	600	10
M20 2.5 mm PITCH	650	10
M20 2.5 mm PITCH	700	10
M20 2.5 mm PITCH	800	10

BOLT, NUT & WASHER ASSEMBLY**DIAMETER M24 3.0mm PITCH CLASS 8.8 METRIC AS1252 – 1983****GALVANISED**

DIAMETER mm	LENGTH mm	STANDARD PACK
M24 3.0 mm PITCH	50	30
M24 3.0 mm PITCH	55	30
M24 3.0 mm PITCH	60	30
M24 3.0 mm PITCH	65	30
M24 3.0 mm PITCH	70	30
M24 3.0 mm PITCH	75	30
M24 3.0 mm PITCH	80	30
M24 3.0 mm PITCH	85	30
M24 3.0 mm PITCH	90	25
M24 3.0 mm PITCH	100	25
M24 3.0 mm PITCH	110	20
M24 3.0 mm PITCH	120	20
M24 3.0 mm PITCH	130	20
M24 3.0 mm PITCH	140	20
M24 3.0 mm PITCH	150	20
M24 3.0 mm PITCH	160	20
M24 3.0 mm PITCH	180	20
M24 3.0 mm PITCH	200	20
M24 3.0 mm PITCH	220	20
M24 3.0 mm PITCH	240	20
M24 3.0 mm PITCH	260	20
M24 3.0 mm PITCH	280	20
M24 3.0 mm PITCH	300	15
M24 3.0 mm PITCH	350	15
M24 3.0 mm PITCH	400	10
M24 3.0 mm PITCH	450	10
M24 3.0 mm PITCH	500	10
M24 3.0 mm PITCH	550	10
M24 3.0 mm PITCH	500	10
M24 3.0 mm PITCH	650	10
M24 3.0 mm PITCH	700	10
M24 3.0 mm PITCH	800	5

BOLT, NUT & WASHER ASSEMBLY**DIAMETER M30 3.5mm PITCH CLASS 8.8 METRIC AS1252 – 1983****GALVANISED**

DIAMETER mm	LENGTH mm	STANDARD PACK
M30 3.5 mm PITCH	75	15
M30 3.5 mm PITCH	80	15
M30 3.5 mm PITCH	85	15
M30 3.5 mm PITCH	90	15
M30 3.5 mm PITCH	100	15
M30 3.5 mm PITCH	110	10
M30 3.5 mm PITCH	120	10
M30 3.5 mm PITCH	130	10
M30 3.5 mm PITCH	140	10
M30 3.5 mm PITCH	150	10
M30 3.5 mm PITCH	160	10
M30 3.5 mm PITCH	180	10
M30 3.5 mm PITCH	200	10
M30 3.5 mm PITCH	220	10
M30 3.5 mm PITCH	240	10
M30 3.5 mm PITCH	250	5
M30 3.5 mm PITCH	260	10
M30 3.5 mm PITCH	280	10
M30 3.5 mm PITCH	300	5
M30 3.5 mm PITCH	350	5
M30 3.5 mm PITCH	400	5
M30 3.5 mm PITCH	450	5
M30 3.5 mm PITCH	500	5
M30 3.5 mm PITCH	550	5
M30 3.5 mm PITCH	600	8
M30 3.5 mm PITCH	650	8
M30 3.5 mm PITCH	700	8
M30 3.5 mm PITCH	800	8

BOLT, NUT & WASHER ASSEMBLY



**DIAMETER M36 4.0mm PITCH CLASS 8.8 METRIC AS1252 – 1983
GALVANISED**

M36 4.0 mm PITCH	90	8
M36 4.0 mm PITCH	100	8
M36 4.0 mm PITCH	120	8
M36 4.0 mm PITCH	130	8
M36 4.0 mm PITCH	140	8
M36 4.0 mm PITCH	150	8
M36 4.0 mm PITCH	160	5
M36 4.0 mm PITCH	180	5
M36 4.0 mm PITCH	200	5
M36 4.0 mm PITCH	220	5
M36 4.0 mm PITCH	240	5
M36 4.0 mm PITCH	260	5
M36 4.0 mm PITCH	300	5

STRUCTURAL NUT – BLACK



METRIC AS1252 – 1983

DIAMETER mm	LENGTH mm	STANDARD PACK
M16		450
M20		250
M24		100
M30		50
M36		25

STRUCTURAL NUT – GALVANISED



METRIC AS1252 – 1983

DIAMETER mm	LENGTH mm	STANDARD PACK
M12		600
M16		450
M20		250
M24		100
M30		50
M36		25

STRUCTURAL WASHERS – BLACK

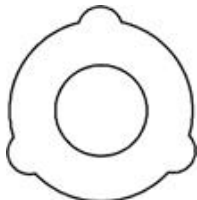

METRIC AS1252 – 1983

DIAMETER mm	LENGTH mm	STANDARD PACK
M12		1000
M16		800
M20		500
M24		350
M30		250
M36		200

STRUCTURAL WASHERS – GALVANISED

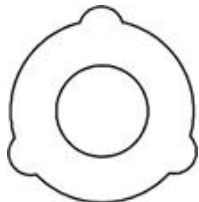

METRIC AS1252 – 1983

DIAMETER mm	LENGTH mm	STANDARD PACK
M12		1000
M16		800
M20		500
M24		350
M30		250
M36		200

LOAD INDICATING WASHERS



BS 7644 – 1993 SHERADIZED

BOLT DIAMETER mm	STANDARD PACK
M12	1000
M16	800
M20	500
M24	350
M30	250



HEXAGON HEAD BOLTS & NUTS

GRADE 5 UNC AS2465 – 1999	BLACK	
DIAMETER	LENGTH	STANDARD
INCHES	INCHES	PACK
¼ 20 TPI	½	200
¼ 20 TPI	¾	200
¼ 20 TPI	1	200
¼ 20 TPI	1. ¼	200
¼ 20 TPI	1. ½	200
¼ 20 TPI	1. ¾	200
¼ 20 TPI	2	200
¼ 20 TPI	2. ¼	150
¼ 20 TPI	2. ½	150
¼ 20 TPI	2. ¾	150
¼ 20 TPI	3	150
¼ 20 TPI	3. ½	150
¼ 20 TPI	4	150
¼ 20 TPI	4. ½	150
¼ 20 TPI	5	100
¼ 20 TPI	5. ½	100
¼ 20 TPI	6	50



HEXAGON HEAD BOLTS & NUTS

GRADE 5 UNC AS2465 – 1999	ZINC PLATED	
DIAMETER	LENGTH	STANDARD
INCHES	INCHES	PACK
¼ 20 TPI	½	200
¼ 20 TPI	¾	200
¼ 20 TPI	1	200
¼ 20 TPI	1. ¼	200
¼ 20 TPI	1. ½	200
¼ 20 TPI	1. ¾	200
¼ 20 TPI	2	200
¼ 20 TPI	2. ¼	150
¼ 20 TPI	2. ½	150
¼ 20 TPI	2. ¾	150

HEXAGON HEAD 1/4 20 TPI
BOLTS & NUTS



GRADE 5 UNC AS2465 – 1999 ZINC PLATED

DIAMETER INCHES	LENGTH INCHES	STANDARD PACK
1/4 20 TPI	3	150
1/4 20 TPI	3. 1/2	150
1/4 20 TPI	4	150
1/4 20 TPI	4. 1/2	150
1/4 20 TPI	5	100
1/4 20 TPI	5. 1/2	100
1/4 20 TPI	6	50

HEXAGON HEAD 5/16 18 TPI
BOLTS & NUTS



GRADE 5 UNC AS2465 – 1999 BLACK

DIAMETER INCHES	LENGTH INCHES	STANDARD PACK
5/16 18 TPI	1/2	200
5/16 18 TPI	3/4	200
5/16 18 TPI	1	200
5/16 18 TPI	1. 1/4	200
5/16 18 TPI	1. 1/2	200
5/16 18 TPI	1. 3/4	150
5/16 18 TPI	2	150
5/16 18 TPI	2. 1/4	150
5/16 18 TPI	2. 1/2	150
5/16 18 TPI	2. 3/4	100
5/16 18 TPI	3	100
5/16 18 TPI	3. 1/2	100
5/16 18 TPI	4	100
5/16 18 TPI	4. 1/2	100
5/16 18 TPI	5	100
5/16 18 TPI	5. 1/2	100
5/16 18 TPI	6	100



HEXAGON HEAD 5/16 18 TPI BOLTS & NUTS

GRADE 5 UNC AS2465 – 1999 ZINK PLATED

DIAMETER INCHES	LENGTH INCHES	STANDARD PACK
5/16 18 TPI	1/2	200
5/16 18 TPI	3/4	200
5/16 18 TPI	1	200
5/16 18 TPI	1. 1/4	200
5/16 18 TPI	1. 1/2	200
5/16 18 TPI	1. 3/4	150
5/16 18 TPI	2	150
5/16 18 TPI	2. 1/4	150
5/16 18 TPI	2. 1/2	150
5/16 18 TPI	2. 3/4	100
5/16 18 TPI	3	100
5/16 18 TPI	3. 1/2	100
5/16 18 TPI	4	100
5/16 18 TPI	4. 1/2	100
5/16 18 TPI	5	100
5/16 18 TPI	5. 1/2	100
5/16 18 TPI	6	100



HEXAGON HEAD 3/8 16 TPI BOLTS & NUTS

GRADE 5 UNC AS2465 – 1999 BLACK

DIAMETER INCHES	LENGTH INCHES	STANDARD PACK
3/8 16 TPI	1/2	200
3/8 16 TPI	3/4	200
3/8 16 TPI	1	200
3/8 16 TPI	1. 1/4	200
3/8 16 TPI	1. 1/2	150
3/8 16 TPI	1. 3/4	150
3/8 16 TPI	2	100
3/8 16 TPI	2. 1/4	100
3/8 16 TPI	2. 1/2	100
3/8 16 TPI	2. 3/4	100



HEXAGON HEAD 3/8 16 TPI BOLTS & NUTS

GRADE 5 UNC AS2465 – 1999	BLACK	
DIAMETER	LENGTH	STANDARD
INCHES	INCHES	PACK
3/8 16 TPI	3	100
3/8 16 TPI	3. ½	50
3/8 16 TPI	4	50
3/8 16 TPI	4. ½	50
3/8 16 TPI	5	50
3/8 16 TPI	5. ½	50
3/8 16 TPI	6	50
3/8 16 TPI	6. ½	50
3/8 16 TPI	7	50



HEXAGON HEAD 3/8 16 TPI BOLTS & NUTS

GRADE 5 UNC AS2465 – 1999	ZINK PLATED	
DIAMETER	LENGTH	STANDARD
INCHES	INCHES	PACK
3/8 16 TPI	1/2	200
3/8 16 TPI	¾	200
3/8 16 TPI	1	200
3/8 16 TPI	1. ¼	200
3/8 16 TPI	1. ½	150
3/8 16 TPI	1. ¾	150
3/8 16 TPI	2	100
3/8 16 TPI	2. ¼	100
3/8 16 TPI	2. ½	100
3/8 16 TPI	2. ¾	100
3/8 16 TPI	3	100
3/8 16 TPI	3. ½	50
3/8 16 TPI	4	50
3/8 16 TPI	4. ½	50
3/8 16 TPI	5	50
3/8 16 TPI	5. ½	50
3/8 16 TPI	6	50
3/8 16 TPI	6. ½	50
3/8 16 TPI	7	50



HEXAGON HEAD 7/16 18 TPI BOLTS & NUTS

GRADE 5 UNC AS2465 – 1999

 DIAMETER
INCHES

 BLACK
LENGTH
INCHES

 STANDARD
PACK

7/16 18 TPI	3/4	100
7/16 18 TPI	1	100
7/16 18 TPI	1. 1/4	100
7/16 18 TPI	1. 1/2	100
7/16 18 TPI	1. 3/4	100
7/16 18 TPI	2	100
7/16 18 TPI	2. 1/4	75
7/16 18 TPI	2. 1/2	75
7/16 18 TPI	2. 3/4	75
7/16 18 TPI	3	75
7/16 18 TPI	3. 1/2	75
7/16 18 TPI	4	50
7/16 18 TPI	4. 1/2	50
7/16 18 TPI	5	50
7/16 18 TPI	5. 1/2	50
7/16 18 TPI	6	50
7/16 18 TPI	6. 1/2	50
7/16 18 TPI	7	50



HEXAGON HEAD 7/16 18 TPI BOLTS & NUTS

GRADE 5 UNC AS2465 – 1999

 DIAMETER
INCHES

 ZINC PLATED
LENGTH
INCHES

 STANDARD
PACK

7/16 18 TPI	3/4	100
7/16 18 TPI	1	100
7/16 18 TPI	1. 1/4	100
7/16 18 TPI	1. 1/2	100
7/16 18 TPI	1. 3/4	100
7/16 18 TPI	2	100
7/16 18 TPI	2. 1/4	75
7/16 18 TPI	2. 1/2	75
7/16 18 TPI	2. 3/4	75
7/16 18 TPI	3	75
7/16 18 TPI	3. 1/2	75



HEXAGON HEAD 7/16 18 TPI BOLTS & NUTS

GRADE 5 UNC AS2465 – 1999 ZINC PLATED

DIAMETER INCHES	LENGTH INCHES	STANDARD PACK
7/16 18 TPI	4	50
7/16 18 TPI	4. ½	50
7/16 18 TPI	5	50
7/16 18 TPI	5. ½	50
7/16 18 TPI	6	50
7/16 18 TPI	6. ½	50
7/16 18 TPI	7	50



HEXAGON HEAD ½ 13 TPI BOLTS & NUTS

GRADE 8 UNC AS2465 – 1999 BLACK

DIAMETER INCHES	LENGTH INCHES	STANDARD PACK
½ 13 TPI	¾	75
½ 13 TPI	1	75
½ 13 TPI	1 ¼	75
½ 13 TPI	1 ½	75
½ 13 TPI	1 ¾	75
½ 13 TPI	2	50
½ 13 TPI	2 ¼	50
½ 13 TPI	2 ½	50
½ 13 TPI	2 ¾	50
½ 13 TPI	3	25
½ 13 TPI	3 ½	25
½ 13 TPI	4	25
½ 13 TPI	4 ½	25
½ 13 TPI	5	25
½ 13 TPI	5 ½	25
½ 13 TPI	6	25
½ 13 TPI	6 ½	20
½ 13 TPI	7	20
½ 13 TPI	7 ½	20
½ 13 TPI	8	20



HEXAGON HEAD ½ 13 TPI BOLTS & NUTS

GRADE 8 UNC AS2465 – 1999 DIAMETER INCHES	BLACK LENGTH INCHES	STANDARD PACK
½ 13 TPI	8 ½	20
½ 13 TPI	9	20
½ 13 TPI	9 ½	20
½ 13 TPI	10	20
½ 13 TPI	11	10
½ 13 TPI	12	10



HEXAGON HEAD ½ 13 TPI BOLTS & NUTS

GRADE 8 UNC AS2465 – 1999 DIAMETER INCHES	ZINC PLATED LENGTH INCHES	STANDARD PACK
½ 13 TPI	¾	75
½ 13 TPI	1	75
½ 13 TPI	1 ¼	75
½ 13 TPI	1 ½	75
½ 13 TPI	1 ¾	75
½ 13 TPI	2	50
½ 13 TPI	2 ¼	50
½ 13 TPI	2 ½	50
½ 13 TPI	2 ¾	50
½ 13 TPI	3	25
½ 13 TPI	3 ½	25
½ 13 TPI	4	25
½ 13 TPI	4 ½	25
½ 13 TPI	5	25
½ 13 TPI	5 ½	25
½ 13 TPI	6	25
½ 13 TPI	6 ½	20
½ 13 TPI	7	20
½ 13 TPI	7 ½	20
½ 13 TPI	8	20



HEXAGON HEAD ½ 13 TPI BOLTS & NUTS

GRADE 8 UNC AS2465 – 1999 ZINC PLATED
 DIAMETER LENGTH
 INCHES INCHES

STANDARD
 PACK

½ 13 TPI	8 ½	20
½ 13 TPI	9	20
½ 13 TPI	9 ½	20
½ 13 TPI	10	20
½ 13 TPI	11	10
½ 13 TPI	12	10



HEXAGON HEAD 9/16 12 TPI BOLTS & NUTS

GRADE 8 UNC AS2465 – 1999 BLACK
 DIAMETER LENGTH
 INCHES INCHES

STANDARD
 PACK

9/16 12 TPI	1	25
9/16 12 TPI	1. ¼	25
9/16 12 TPI	1. ½	25
9/16 12 TPI	1. ¾	25
9/16 12 TPI	2	25
9/16 12 TPI	2. ¼	25
9/16 12 TPI	2. ½	25
9/16 12 TPI	2. ¾	25
9/16 12 TPI	3	25
9/16 12 TPI	3. ½	25
9/16 12 TPI	4	25
9/16 12 TPI	4. ½	15
9/16 12 TPI	5	15
9/16 12 TPI	5. ½	15
9/16 12 TPI	6	15



HEXAGON HEAD 9/16 12 TPI
BOLTS & NUTS

GRADE 8 UNC AS2465 – 1999

ZINC PLATED

DIAMETER INCHES	LENGTH INCHES	STANDARD PACK
9/16 12 TPI	1	25
9/16 12 TPI	1. ¼	25
9/16 12 TPI	1. ½	25
9/16 12 TPI	1. ¾	25
9/16 12 TPI	2	25
9/16 12 TPI	2. ¼	25
9/16 12 TPI	2. ½	25
9/16 12 TPI	2. ¾	25
9/16 12 TPI	3	25
9/16 12 TPI	3. ½	25
9/16 12 TPI	4	25
9/16 12 TPI	4. ½	15
9/16 12 TPI	5	15
9/16 12 TPI	5. ½	15
9/16 12 TPI	6	15



HEXAGON HEAD 5/8 11TPI
BOLTS & NUTS

GRADE 8 UNC AS2465 – 1999

ZINC PLATED

DIAMETER INCHES	LENGTH INCHES	STANDARD PACK
5/8 11 TPI	1	25
5/8 11 TPI	1. ¼	25
5/8 11 TPI	1. ½	25
5/8 11 TPI	1. ¾	25
5/8 11 TPI	2	25
5/8 11 TPI	2. ¼	25
5/8 11 TPI	2. ½	25
5/8 11 TPI	2. ¾	25
5/8 11 TPI	3	25
5/8 11 TPI	3. ½	25
5/8 11 TPI	4	25
5/8 11 TPI	4. ½	15
5/8 11 TPI	5	15
5/8 11 TPI	5 ½	15



HEXAGON HEAD 5/8 11TPI BOLTS & NUTS

GRADE 8 UNC AS2465 – 1999 ZINC PLATED

DIAMETER INCHES	LENGTH INCHES	STANDARD PACK
--------------------	------------------	------------------

5/8 11 TPI	6	15
5/8 11 TPI	6. ½	15
5/8 11 TPI	7	15
5/8 11 TPI	7. ½	15
5/8 11 TPI	8	15
5/8 11 TPI	8. ½	15
5/8 11 TPI	9	15
5/8 11 TPI	9. ½	15
5/8 11 TPI	10	15
5/8 11 TPI	11	20
5/8 11 TPI	12	20



HEXAGON HEAD 5/8 11TPI BOLTS & NUTS

GRADE 8 UNC AS2465 – 1999 BLACK

DIAMETER INCHES	LENGTH INCHES	STANDARD PACK
--------------------	------------------	------------------

5/8 11 TPI	1	25
5/8 11 TPI	1. ¼	25
5/8 11 TPI	1. ½	25
5/8 11 TPI	1. ¾	25
5/8 11 TPI	2	25
5/8 11 TPI	2. ¼	25
5/8 11 TPI	2. ½	25
5/8 11 TPI	2. ¾	25
5/8 11 TPI	3	25
5/8 11 TPI	3. ½	25
5/8 11 TPI	4	25
5/8 11 TPI	4. ½	15
5/8 11 TPI	5	15
5/8 11 TPI	5 ½	15



HEXAGON HEAD 5/8 11TPI
BOLTS & NUTS

GRADE 8 UNC AS2465 – 1999 DIAMETER INCHES	BLACK LENGTH INCHES	STANDARD PACK
5/8 11 TPI	6	15
5/8 11 TPI	6. ½	15
5/8 11 TPI	7	15
5/8 11 TPI	7. ½	15
5/8 11 TPI	8	15
5/8 11 TPI	8. ½	15
5/8 11 TPI	9	15
5/8 11 TPI	9. ½	15
5/8 11 TPI	10	15
5/8 11 TPI	11	20
5/8 11 TPI	12	20



HEXAGON HEAD ¾ 10TPI
BOLTS & NUTS

GRADE 8 UNC AS2465 – 1999 DIAMETER INCHES	BLACK LENGTH INCHES	STANDARD PACK
¾ 10 TPI	1	25
¾ 10 TPI	1. ¼	25
¾ 10 TPI	1. ½	25
¾ 10 TPI	1. ¾	25
¾ 10 TPI	2	25
¾ 10 TPI	2. ¼	25
¾ 10 TPI	2. ½	20
¾ 10 TPI	2. ¾	20
¾ 10 TPI	3	20
¾ 10 TPI	3. ½	20
¾ 10 TPI	4	10
¾ 10 TPI	4. ½	10
¾ 10 TPI	5	10
¾ 10 TPI	5. ½	10
¾ 10 TPI	6	10
¾ 10 TPI	6. ½	10
¾ 10 TPI	7	10
¾ 10 TPI	7. ½	10



HEXAGON HEAD $\frac{3}{4}$ 10TPI BOLTS & NUTS

GRADE 8 UNC AS2465 – 1999 BLACK
 DIAMETER LENGTH STANDARD
 INCHES INCHES PACK

$\frac{3}{4}$ 10 TPI	8	10
$\frac{3}{4}$ 10 TPI	8. $\frac{1}{2}$	5
$\frac{3}{4}$ 10 TPI	9	5
$\frac{3}{4}$ 10 TPI	9. $\frac{1}{2}$	5
$\frac{3}{4}$ 10 TPI	10	5
$\frac{3}{4}$ 10 TPI	11	5
$\frac{3}{4}$ 10 TPI	12	5



HEXAGON HEAD $\frac{3}{4}$ 10TPI BOLTS & NUTS

GRADE 8 UNC AS2465 – 1999 ZINC PLATED
 DIAMETER LENGTH STANDARD
 INCHES INCHES PACK

$\frac{3}{4}$ 10 TPI	1	25
$\frac{3}{4}$ 10 TPI	1. $\frac{1}{4}$	25
$\frac{3}{4}$ 10 TPI	1. $\frac{1}{2}$	25
$\frac{3}{4}$ 10 TPI	1. $\frac{3}{4}$	25
$\frac{3}{4}$ 10 TPI	2	25
$\frac{3}{4}$ 10 TPI	2. $\frac{1}{4}$	25
$\frac{3}{4}$ 10 TPI	2. $\frac{1}{2}$	20
$\frac{3}{4}$ 10 TPI	2. $\frac{3}{4}$	20
$\frac{3}{4}$ 10 TPI	3	20
$\frac{3}{4}$ 10 TPI	3. $\frac{1}{2}$	20
$\frac{3}{4}$ 10 TPI	4	10
$\frac{3}{4}$ 10 TPI	4. $\frac{1}{2}$	10
$\frac{3}{4}$ 10 TPI	5	10
$\frac{3}{4}$ 10 TPI	5. $\frac{1}{2}$	10
$\frac{3}{4}$ 10 TPI	6	10
$\frac{3}{4}$ 10 TPI	6. $\frac{1}{2}$	10
$\frac{3}{4}$ 10 TPI	7	10
$\frac{3}{4}$ 10 TPI	7. $\frac{1}{2}$	10

**HEXAGON HEAD 3/4 10TPI
 BOLTS & NUTS**



GRADE 8 UNC AS2465 – 1999 DIAMETER INCHES	ZINC PLATED LENGTH INCHES	STANDARD PACK
3/4 10 TPI	8	10
3/4 10 TPI	8. 1/2	5
3/4 10 TPI	9	5
3/4 10 TPI	9. 1/2	5
3/4 10 TPI	10	5
3/4 10 TPI	11	5
3/4 10 TPI	12	5

**HEXAGON HEAD 7/8 9TPI
 BOLTS & NUTS**



GRADE 8 UNC AS2465 – 1999 DIAMETER INCHES	BLACK LENGTH INCHES	STANDARD PACK
7/8 9TPI	1. 1/2	10
7/8 9TPI	1. 3/4	10
7/8 9TPI	2	10
7/8 9TPI	2. 1/4	10
7/8 9TPI	2. 1/2	10
7/8 9TPI	2. 3/4	10
7/8 9TPI	3	10
7/8 9TPI	3. 1/2	10
7/8 9TPI	4	10
7/8 9TPI	4. 1/2	10
7/8 9TPI	5	10
7/8 9TPI	5. 1/2	10
7/8 9TPI	6	10
7/8 9TPI	6. 1/2	5

7/8 9TPI	7	5
7/8 9TPI	7. ½	5
7/8 9TPI	8	5
7/8 9TPI	8. ½	5
7/8 9TPI	9	5
7/8 9TPI	9. ½	5
7/8 9TPI	10	5
7/8 9TPI	11	5
7/8 9TPI	12	5



HEXAGON HEAD 7/8 9TPI BOLTS & NUTS

GRADE 8 UNC AS2465 – 1999 ZINC PLATED

DIAMETER INCHES	LENGTH INCHES	STANDARD PACK
7/8 9TPI	1. ½	10
7/8 9TPI	1. ¾	10
7/8 9TPI	2	10
7/8 9TPI	2. ¼	10
7/8 9TPI	2. ½	10
7/8 9TPI	2. ¾	10
7/8 9TPI	3	10
7/8 9TPI	3. ½	10
7/8 9TPI	4	10
7/8 9TPI	4. ½	10
7/8 9TPI	5	10
7/8 9TPI	5. ½	10
7/8 9TPI	6	10
7/8 9TPI	6. ½	5
7/8 9TPI	7	5
7/8 9TPI	7. ½	5
7/8 9TPI	8	5
7/8 9TPI	8. ½	5
7/8 9TPI	9	5
7/8 9TPI	9. ½	5
7/8 9TPI	10	5
7/8 9TPI	11	5
7/8 9TPI	12	5



HEXAGON HEAD 1 8TPI BOLTS & NUTS

GRADE 8 UNC AS2465 – 1999 BLACK
 DIAMETER LENGTH STANDARD
 INCHES INCHES PACK

1 8TPI	LENGTH INCHES	STANDARD PACK
1 8TPI	2	5
1 8TPI	2. ¼	5
1 8TPI	2. ½	5
1 8TPI	2. ¾	5
1 8TPI	3	5
1 8TPI	3. ½	5
1 8TPI	4	5
1 8TPI	4. ½	5
1 8TPI	5	5
1 8TPI	5. ½	5
1 8TPI	6	5
1 8TPI	6. ½	5
1 8TPI	7	5
1 8TPI	7. ½	5
1 8TPI	8	5
1 8TPI	8. ½	5
1 8TPI	9	5
1 8TPI	9. ½	5
1 8TPI	10	5
1 8TPI	11	5
1 8TPI	12	5



HEXAGON HEAD 1 8TPI BOLTS & NUTS

GRADE 8 UNC AS2465 – 1999 ZINC PLATED

DIAMETER INCHES	LENGTH INCHES	STANDARD PACK
1 8TPI	2	5
1 8TPI	2. ¼	5
1 8TPI	2. ½	5
1 8TPI	2. ¾	5
1 8TPI	3	5
1 8TPI	3. ½	5
1 8TPI	4	5
1 8TPI	4. ½	5
1 8TPI	5	5
1 8TPI	5. ½	5
1 8TPI	6	5
1 8TPI	6. ½	5
1 8TPI	7	5
1 8TPI	7. ½	5
1 8TPI	8	5
1 8TPI	8. ½	5
1 8TPI	9	5
1 8TPI	9. ½	5
1 8TPI	10	5
1 8TPI	11	5
1 8TPI	12	5



HEXAGON HEAD 1.1/8 7TPI BOLTS & NUTS

GRADE 8 UNC AS2465 – 1999 ZINC PLATED

DIAMETER INCHES	LENGTH INCHES	STANDARD PACK
1.1/8 7TPI	2. ½	5
1.1/8 7TPI	3	5
1.1/8 7TPI	3. ½	5
1.1/8 7TPI	4	5
1.1/8 7TPI	4. ½	5
1.1/8 7TPI	5	5
1.1/8 7TPI	5. ½	5



HEXAGON HEAD 1.1/8 7TPI BOLTS & NUTS

GRADE 8 UNC AS2465 – 1999 ZINC PLATED

DIAMETER INCHES	LENGTH INCHES	STANDARD PACK
--------------------	------------------	------------------

1.1/8 7TPI	6	5
1.1/8 7TPI	6. ½	5
1.1/8 7TPI	7	5
1.1/8 7TPI	7. ½	5
1.1/8 7TPI	8	5
1.1/8 7TPI	8. ½	5
1.1/8 7TPI	9	5
1.1/8 7TPI	9. ½	5
1.1/8 7TPI	10	5
1.1/8 7TPI	11	5
1.1/8 7TPI	12	5

HEXAGON HEAD 1.1/8 7TPI BOLTS & NUTS

GRADE 8 UNC AS2465 – 1999 BLACK

DIAMETER INCHES	LENGTH INCHES	STANDARD PACK
--------------------	------------------	------------------

1.1/4 7TPI	3	4
1.1/4 7TPI	3. ½	4
1.1/4 7TPI	4	4
1.1/4 7TPI	4. ½	4
1.1/4 7TPI	5	4
1.1/4 7TPI	5. ½	4
1.1/4 7TPI	6	4
1.1/4 7TPI	6. ½	4
1.1/4 7TPI	7	4
1.1/4 7TPI	7. ½	4
1.1/4 7TPI	8	4
1.1/4 7TPI	8. ½	4
1.1/4 7TPI	9	4
1.1/4 7TPI	9. ½	4
1.1/4 7TPI	10	4
1.1/4 7TPI	11	4
1.1/4 7TPI	12	4



HEXAGON HEAD 1. ½ 6TPI
BOLTS & NUTS

GRADE 8 UNC AS2465 – 1999

DIAMETER INCHES	BLACK LENGTH INCHES	STANDARD PACK
1.½ 6TPI	3	3
1.½ 6TPI	3. ½	3
1.½ 6TPI	4	3
1.½ 6TPI	4. ½	3
1.½ 6TPI	5	3
1.½ 6TPI	5. ½	3
1.½ 6TPI	6	3
1.½ 6TPI	6. ½	3
1.½ 6TPI	7	3
1.½ 6TPI	7. ½	3
1.½ 6TPI	8	3
1.½ 6TPI	8. ½	3
1.½ 6TPI	9	3
1.½ 6TPI	9. ½	3
1.½ 6TPI	10	3
1.½ 6TPI	11	3
1.½ 6TPI	12	3



HEXAGON HEAD ¼ 28TPI
BOLTS & NUTS

GRADE 5 UNC AS2465 – 1999

DIAMETER INCHES	BLACK LENGTH INCHES	STANDARD PACK
¼ 28TPI	½	200
¼ 28TPI	¾	200
¼ 28TPI	1	200
¼ 28TPI	1. ¼	200
¼ 28TPI	1. ½	200
¼ 28TPI	1. ¾	200
¼ 28TPI	2	200
¼ 28TPI	2. ¼	150
¼ 28TPI	2. ½	150
¼ 28TPI	2. ¾	150
¼ 28TPI	3	150
¼ 28TPI	3. ½	150



HEXAGON HEAD ¼ 28TPI BOLTS & NUTS

GRADE 5 UNC AS2465 – 1999 BLACK
 DIAMETER LENGTH STANDARD
 INCHES INCHES PACK

¼ 28TPI	4	150
¼ 28TPI	4. ½	100
¼ 28TPI	5	100
¼ 28TPI	5. ½	100
¼ 28TPI	6	50



HEXAGON HEAD ¼ 28TPI BOLTS & NUTS

GRADE 5 UNC AS2465 – 1999 ZINC PLATED
 DIAMETER LENGTH STANDARD
 INCHES INCHES PACK

¼ 28TPI	½	200
¼ 28TPI	¾	200
¼ 28TPI	1	200
¼ 28TPI	1. ¼	200
¼ 28TPI	1. ½	200
¼ 28TPI	1. ¾	200
¼ 28TPI	2	200
¼ 28TPI	2. ¼	150
¼ 28TPI	2. ½	150
¼ 28TPI	2. ¾	150
¼ 28TPI	3	150
¼ 28TPI	3. ½	150
¼ 28TPI	4	150
¼ 28TPI	4. ½	100
¼ 28TPI	5	100
¼ 28TPI	5. ½	100
¼ 28TPI	6	50



HEXAGON HEAD 5/6 24TPI BOLTS & NUTS

GRADE 5 UNC AS2465 – 1999	BLACK	
DIAMETER	LENGTH	STANDARD
INCHES	INCHES	PACK
5/6 24TPI	½	200
5/6 24TPI	¾	200
5/6 24TPI	1	200
5/6 24TPI	1. ¼	200
5/6 24TPI	1. ½	200
5/6 24TPI	1. ¾	150
5/6 24TPI	2	150
5/6 24TPI	2. ¼	150
5/6 24TPI	2. ½	150
5/6 24TPI	2. ¾	100
5/6 24TPI	3	100
5/6 24TPI	3. ½	100
5/6 24TPI	4	100
5/6 24TPI	4. ½	100
5/6 24TPI	5	100
5/6 24TPI	5. ½	100
5/6 24TPI	6	100



HEXAGON HEAD 5/6 24TPI BOLTS & NUTS

GRADE 5 UNC AS2465 – 1999	ZINC PLATED	
DIAMETER	LENGTH	STANDARD
INCHES	INCHES	PACK
5/6 24TPI	½	200
5/6 24TPI	¾	200
5/6 24TPI	1	200
5/6 24TPI	1. ¼	200

5/6 24TPI	1. ½	200
5/6 24TPI	1. ¾	150
5/6 24TPI	2	150
5/6 24TPI	2. ¼	150
5/6 24TPI	2. ½	150
5/6 24TPI	2. ¾	100
5/6 24TPI	3	100
5/6 24TPI	3. ½	100
5/6 24TPI	4	100



HEXAGON HEAD 5/6 24TPI BOLTS & NUTS

GRADE 5 UNC AS2465 – 1999 ZINC PLATED

DIAMETER INCHES	LENGTH INCHES	STANDARD PACK
5/6 24TPI	4. ½	100
5/6 24TPI	5	100
5/6 24TPI	5. ½	100
5/6 24TPI	6	100



HEXAGON HEAD 3/8 24TPI BOLTS & NUTS

GRADE 5 UNC AS2465 – 1999 BLACK

DIAMETER INCHES	LENGTH INCHES	STANDARD PACK
3/8 24TPI	½	200
3/8 24TPI	¾	200
3/8 24TPI	1	200
3/8 24TPI	1. ¼	200
3/8 24TPI	1. ½	150
3/8 24TPI	1. ¾	150
3/8 24TPI	2	100
3/8 24TPI	2. ¼	100
3/8 24TPI	2. ½	100

3/8 24TPI	2. 3/4	100
3/8 24TPI	3	100
3/8 24TPI	3. 1/2	50
3/8 24TPI	4	50
3/8 24TPI	4. 1/2	50
3/8 24TPI	5	50
3/8 24TPI	5. 1/2	50
3/8 24TPI	6	50
3/8 24TPI	6. 1/2	50
3/8 24TPI	7	50



HEXAGON HEAD 3/8 24TPI BOLTS & NUTS

GRADE 5 UNC AS2465 – 1999 ZINC PLATED

DIAMETER INCHES	LENGTH INCHES	STANDARD PACK
3/8 24TPI	1/2	200
3/8 24TPI	3/4	200
3/8 24TPI	1	200
3/8 24TPI	1. 1/4	200
3/8 24TPI	1. 1/2	150
3/8 24TPI	1. 3/4	150
3/8 24TPI	2	100
3/8 24TPI	2. 1/4	100
3/8 24TPI	2. 1/2	100
3/8 24TPI	2. 3/4	100
3/8 24TPI	3	100
3/8 24TPI	3. 1/2	50
3/8 24TPI	4	50
3/8 24TPI	4. 1/2	50
3/8 24TPI	5	50
3/8 24TPI	5. 1/2	50
3/8 24TPI	6	50
3/8 24TPI	6. 1/2	50
3/8 24TPI	7	50



HEXAGON HEAD 7/16 20TPI BOLTS & NUTS

GRADE 5 UNC AS2465 – 1999

DIAMETER INCHES	LENGTH INCHES	BLACK	STANDARD PACK
7/16 20TPI	3/4		100
7/16 20TPI	1		100
7/16 20TPI	1. 1/4		100
7/16 20TPI	1. 1/2		100
7/16 20TPI	1. 3/4		100
7/16 20TPI	2		100
7/16 20TPI	2. 1/4		75
7/16 20TPI	2. 1/2		75
7/16 20TPI	2. 3/4		75
7/16 20TPI	3		75
7/16 20TPI	3. 1/2		75



HEXAGON HEAD 7/16 20TPI BOLTS & NUTS

GRADE 5 UNC AS2465 – 1999

DIAMETER INCHES	LENGTH INCHES	BLACK	STANDARD PACK
7/16 20TPI	4		50
7/16 20TPI	4. 1/2		50
7/16 20TPI	5		50
7/16 20TPI	5. 1/2		50
7/16 20TPI	6		50
7/16 20TPI	6. 1/2		50
7/16 20TPI	7		50



HEXAGON HEAD 7/16 20TPI BOLTS & NUTS

GRADE 5 UNC AS2465 – 1999 ZINC PLATED

DIAMETER INCHES	LENGTH INCHES	STANDARD PACK
--------------------	------------------	------------------

7/16 20TPI	$\frac{3}{4}$	100
7/16 20TPI	1	100
7/16 20TPI	1. $\frac{1}{4}$	100
7/16 20TPI	1. $\frac{1}{2}$	100
7/16 20TPI	1. $\frac{3}{4}$	100
7/16 20TPI	2	100
7/16 20TPI	2. $\frac{1}{4}$	75
7/16 20TPI	2. $\frac{1}{2}$	75
7/16 20TPI	2. $\frac{3}{4}$	75
7/16 20TPI	3	75
7/16 20TPI	3. $\frac{1}{2}$	75
7/16 20TPI	4	50
7/16 20TPI	4. $\frac{1}{2}$	50
7/16 20TPI	5	50
7/16 20TPI	5. $\frac{1}{2}$	50
7/16 20TPI	6	50
7/16 20TPI	6. $\frac{1}{2}$	50
7/16 20TPI	7	50



HEXAGON HEAD ½ 20 TPI BOLTS & NUTS

GRADE 8 UNC AS2465 – 1999 BLACK
 DIAMETER LENGTH STANDARD
 INCHES INCHES PACK

DIAMETER INCHES	LENGTH INCHES	STANDARD PACK
½ 20 TPI	¾	75
½ 20 TPI	1	75
½ 20 TPI	1 ¼	75
½ 20 TPI	1 ½	75
½ 20 TPI	1 ¾	75
½ 20 TPI	2	50
½ 20 TPI	2 ¼	50
½ 20 TPI	2 ½	50
½ 20 TPI	2 ¾	50
½ 20 TPI	3	25
½ 20 TPI	3 ½	25
½ 20 TPI	4	25
½ 20 TPI	4 ½	25
½ 20 TPI	5	25
½ 20 TPI	5 ½	25
½ 20 TPI	6	25
½ 20 TPI	6 ½	20
½ 20 TPI	7	20
½ 20 TPI	7 ½	20
½ 20 TPI	8	20
½ 20 TPI	8 ½	20
½ 20 TPI	9	20
½ 20 TPI	9 ½	20
½ 20 TPI	10	20



HEXAGON HEAD ½ 20 TPI BOLTS & NUTS

GRADE 8 UNC AS2465 – 1999 ZINC PLATED
 DIAMETER LENGTH
 INCHES INCHES

STANDARD
 PACK

½ 20 TPI	LENGTH INCHES	STANDARD PACK
½ 20 TPI	¾	75
½ 20 TPI	1	75
½ 20 TPI	1 ¼	75
½ 20 TPI	1 ½	75
½ 20 TPI	1 ¾	75
½ 20 TPI	2	50
½ 20 TPI	2 ¼	50
½ 20 TPI	2 ½	50
½ 20 TPI	2 ¾	50
½ 20 TPI	3	25
½ 20 TPI	3 ½	25
½ 20 TPI	4	25
½ 20 TPI	4 ½	25
½ 20 TPI	5	25
½ 20 TPI	5 ½	25
½ 20 TPI	6	25
½ 20 TPI	6 ½	20
½ 20 TPI	7	20
½ 20 TPI	7 ½	20
½ 20 TPI	8	20
½ 20 TPI	8 ½	20
½ 20 TPI	9	20
½ 20 TPI	9 ½	20
½ 20 TPI	10	20



HEXAGON HEAD 9/16 18TPI BOLTS & NUTS

GRADE 8 UNC AS2465 – 1999 ZINC PLATED

DIAMETER INCHES	LENGTH INCHES	STANDARD PACK
9/16 18TPI	1	25
9/16 18TPI	1. ¼	25
9/16 18TPI	1. ½	25
9/16 18TPI	1. ¾	25
9/16 18TPI	2. ¼	25
9/16 18TPI	2. ½	25
9/16 18TPI	2. ¾	25
9/16 18TPI	3	25
9/16 18TPI	3. ½	25
9/16 18TPI	4	25
9/16 18TPI	4. ½	15
9/16 18TPI	5	15
9/16 18TPI	5. ½	15
9/16 18TPI	6	15



HEXAGON HEAD 9/16 18TPI BOLTS & NUTS

GRADE 8 UNC AS2465 – 1999 BLACK

DIAMETER INCHES	LENGTH INCHES	STANDARD PACK
9/16 18TPI	1	25
9/16 18TPI	1. ¼	25
9/16 18TPI	1. ½	25
9/16 18TPI	1. ¾	25
9/16 18TPI	2. ¼	25
9/16 18TPI	2. ½	25
9/16 18TPI	2. ¾	25
9/16 18TPI	3	25
9/16 18TPI	3. ½	25
9/16 18TPI	4	25
9/16 18TPI	4. ½	15
9/16 18TPI	5	15
9/16 18TPI	5. ½	15
9/16 18TPI	6	15



HEXAGON HEAD 5/8 18TPI BOLTS & NUTS

GRADE 8 UNC AS2465 – 1999 BLACK
 DIAMETER LENGTH STANDARD
 INCHES INCHES PACK

5/8 18TPI	LENGTH INCHES	STANDARD PACK
5/8 18TPI	1	25
5/8 18TPI	1. ¼	25
5/8 18TPI	1. ½	25
5/8 18TPI	1. ¾	25
5/8 18TPI	2	25
5/8 18TPI	2. ¼	25
5/8 18TPI	2. ½	25
5/8 18TPI	2. ¾	25
5/8 18TPI	3	25
5/8 18TPI	3. ½	25
5/8 18TPI	4	25
5/8 18TPI	4. ½	15
5/8 18TPI	5	15
5/8 18TPI	5. ½	15
5/8 18TPI	6	15
5/8 18TPI	6. ½	15
5/8 18TPI	7	15
5/8 18TPI	7. ½	15
5/8 18TPI	8	15
5/8 18TPI	8. ½	15
5/8 18TPI	9	15
5/8 18TPI	9. ½	15
5/8 18TPI	10	15



HEXAGON HEAD 5/8 18TPI BOLTS & NUTS

GRADE 8 UNC AS2465 – 1999 ZINC PLATED

DIAMETER INCHES	LENGTH INCHES	STANDARD PACK
5/8 18TPI	1	25
5/8 18TPI	1. ¼	25
5/8 18TPI	1. ½	25
5/8 18TPI	1. ¾	25
5/8 18TPI	2	25
5/8 18TPI	2. ¼	25
5/8 18TPI	2. ½	25
5/8 18TPI	2. ¾	25
5/8 18TPI	3	25
5/8 18TPI	3. ½	25
5/8 18TPI	4	25
5/8 18TPI	4. ½	15
5/8 18TPI	5	15
5/8 18TPI	5. ½	15
5/8 18TPI	6	15
5/8 18TPI	6. ½	15
5/8 18TPI	7	15
5/8 18TPI	7. ½	15
5/8 18TPI	8	15
5/8 18TPI	8. ½	15
5/8 18TPI	9	15
5/8 18TPI	9. ½	15
5/8 18TPI	10	15



HEXAGON HEAD $\frac{3}{4}$ 16TPI BOLTS & NUTS

GRADE 8 UNC AS2465 – 1999
 DIAMETER
 INCHES

BLACK
 LENGTH
 INCHES

STANDARD
 PACK

DIAMETER INCHES	LENGTH INCHES	STANDARD PACK
$\frac{3}{4}$ 16TPI	1	25
$\frac{3}{4}$ 16TPI	1. $\frac{1}{4}$	25
$\frac{3}{4}$ 16TPI	1. $\frac{1}{2}$	25
$\frac{3}{4}$ 16TPI	1. $\frac{3}{4}$	25
$\frac{3}{4}$ 16TPI	2	25
$\frac{3}{4}$ 16TPI	2. $\frac{1}{4}$	25
$\frac{3}{4}$ 16TPI	2. $\frac{1}{2}$	20
$\frac{3}{4}$ 16TPI	2. $\frac{3}{4}$	20
$\frac{3}{4}$ 16TPI	3	20
$\frac{3}{4}$ 16TPI	3. $\frac{1}{2}$	20
$\frac{3}{4}$ 16TPI	4	10
$\frac{3}{4}$ 16TPI	4. $\frac{1}{2}$	10
$\frac{3}{4}$ 16TPI	5	10
$\frac{3}{4}$ 16TPI	5. $\frac{1}{2}$	10
$\frac{3}{4}$ 16TPI	6	10
$\frac{3}{4}$ 16TPI	6. $\frac{1}{2}$	10
$\frac{3}{4}$ 16TPI	7	10
$\frac{3}{4}$ 16TPI	7. $\frac{1}{2}$	10
$\frac{3}{4}$ 16TPI	8	10
$\frac{3}{4}$ 16TPI	8. $\frac{1}{2}$	5
$\frac{3}{4}$ 16TPI	9	5
$\frac{3}{4}$ 16TPI	9. $\frac{1}{2}$	5
$\frac{3}{4}$ 16TPI	10	5



HEXAGON HEAD $\frac{3}{4}$ 16TPI BOLTS & NUTS

GRADE 8 UNC AS2465 – 1999 ZINC PLATED

DIAMETER INCHES LENGTH INCHES STANDARD PACK

$\frac{3}{4}$ 16TPI	1	25
$\frac{3}{4}$ 16TPI	1. $\frac{1}{4}$	25
$\frac{3}{4}$ 16TPI	1. $\frac{1}{2}$	25
$\frac{3}{4}$ 16TPI	1. $\frac{3}{4}$	25
$\frac{3}{4}$ 16TPI	2	25
$\frac{3}{4}$ 16TPI	2. $\frac{1}{4}$	25
$\frac{3}{4}$ 16TPI	2. $\frac{1}{2}$	20
$\frac{3}{4}$ 16TPI	2. $\frac{3}{4}$	20
$\frac{3}{4}$ 16TPI	3	20
$\frac{3}{4}$ 16TPI	3. $\frac{1}{2}$	20
$\frac{3}{4}$ 16TPI	4	10
$\frac{3}{4}$ 16TPI	4. $\frac{1}{2}$	10
$\frac{3}{4}$ 16TPI	5	10
$\frac{3}{4}$ 16TPI	5. $\frac{1}{2}$	10
$\frac{3}{4}$ 16TPI	6	10
$\frac{3}{4}$ 16TPI	6. $\frac{1}{2}$	10
$\frac{3}{4}$ 16TPI	7	10
$\frac{3}{4}$ 16TPI	7. $\frac{1}{2}$	10
$\frac{3}{4}$ 16TPI	8	10
$\frac{3}{4}$ 16TPI	8. $\frac{1}{2}$	5
$\frac{3}{4}$ 16TPI	9	5
$\frac{3}{4}$ 16TPI	9. $\frac{1}{2}$	5
$\frac{3}{4}$ 16TPI	10	5



HEXAGON HEAD 7/8 14TPI
BOLTS & NUTS

GRADE 8 UNC AS2465 – 1999

DIAMETER
 INCHES

BLACK
 LENGTH
 INCHES

STANDARD
 PACK

7/8 14TPI	1. ½	10
7/8 14TPI	1. ¾	10
7/8 14TPI	2	10
7/8 14TPI	2. ¼	10
7/8 14TPI	2. ½	10
7/8 14TPI	2. ¾	10
7/8 14TPI	3	10
7/8 14TPI	3. ½	10
7/8 14TPI	4	10
7/8 14TPI	4. ½	10
7/8 14TPI	5	10
7/8 14TPI	5. ½	10
7/8 14TPI	6	10
7/8 14TPI	6. ½	5
7/8 14TPI	7	5
7/8 14TPI	7. ½	5
7/8 14TPI	8	5
7/8 14TPI	8. ½	5
7/8 14TPI	9	5
7/8 14TPI	9. ½	5
7/8 14TPI	10	5



HEXAGON HEAD 7/8 14TPI
BOLTS & NUTS

GRADE 8 UNC AS2465 – 1999

DIAMETER
 INCHES

ZINC PLATED
 LENGTH
 INCHES

STANDARD
 PACK

7/8 14TPI	1. ½	10
7/8 14TPI	1. ¾	10
7/8 14TPI	2	10
7/8 14TPI	2. ¼	10
7/8 14TPI	2. ½	10
7/8 14TPI	2. ¾	10
7/8 14TPI	3	10
7/8 14TPI	3. ½	10



HEXAGON HEAD 7/8 14TPI BOLTS & NUTS

GRADE 8 UNC AS2465 – 1999 ZINC PLATED

DIAMETER INCHES	LENGTH INCHES	STANDARD PACK
--------------------	------------------	------------------

7/8 14TPI	4	10
7/8 14TPI	4. ½	10
7/8 14TPI	5	10
7/8 14TPI	5. ½	10
7/8 14TPI	6	10
7/8 14TPI	6. ½	5
7/8 14TPI	7	5
7/8 14TPI	7. ½	5
7/8 14TPI	8	5
7/8 14TPI	8. ½	5
7/8 14TPI	9	5
7/8 14TPI	9. ½	5
7/8 14TPI	10	5



HEXAGON HEAD 1 14TPI BOLTS & NUTS

GRADE 8 UNC AS2465 – 1999 BLACK

DIAMETER INCHES	LENGTH INCHES	STANDARD PACK
--------------------	------------------	------------------

1 14TPI	2	5
1 14TPI	2. ¼	5
1 14TPI	2. ½	5
1 14TPI	2. ¾	5
1 14TPI	3	5
1 14TPI	3. 1/2	5
1 14TPI	4	5
1 14TPI	4. ½	5
1 14TPI	5	5
1 14TPI	5. ½	5
1 14TPI	6	5
1 14TPI	6. ½	5
1 14TPI	7	5
1 14TPI	7. ½	5



HEXAGON HEAD 1 14TPI BOLTS & NUTS

GRADE 8 UNC AS2465 – 1999	BLACK	
DIAMETER	LENGTH	STANDARD
INCHES	INCHES	PACK
1 14TPI	8	5
1 14TPI	8. ½	5
1 14TPI	9	5
1 14TPI	9. ½	5
1 14TPI	10	5
1 14TPI	11	5
1 14TPI	12	5



HEXAGON HEAD 1 14TPI BOLTS & NUTS

GRADE 8 UNC AS2465 – 1999	ZINC PLATED	
DIAMETER	LENGTH	STANDARD
INCHES	INCHES	PACK
1 14TPI	2	5
1 14TPI	2. ¼	5
1 14TPI	2. ½	5
1 14TPI	2. ¾	5
1 14TPI	3	5
1 14TPI	3. ½	5
1 14TPI	4	5
1 14TPI	4. ½	5
1 14TPI	5	5
1 14TPI	5. ½	5
1 14TPI	6	5
1 14TPI	6. ½	5
1 14TPI	7	5
1 14TPI	7. ½	5
1 14TPI	8	5
1 14TPI	8. ½	5
1 14TPI	9	5
1 14TPI	9. ½	5
1 14TPI	10	5
1 14TPI	11	5
1 14TPI	12	5



HEXAGON HEAD M6 1.0mm PITCH BOLTS & NUTS

CLASS 8.8 AS 1110 – 2000 / AS 1112 – 2000 BLACK

DIAMETER mm	LENGTH mm	STANDARD PACK
M6 1.0 mm PITCH	12	200
M6 1.0 mm PITCH	16	200
M6 1.0 mm PITCH	20	200
M6 1.0 mm PITCH	25	200
M6 1.0 mm PITCH	30	200
M6 1.0 mm PITCH	35	200
M6 1.0 mm PITCH	40	200
M6 1.0 mm PITCH	45	200
M6 1.0 mm PITCH	50	200
M6 1.0 mm PITCH	55	150
M6 1.0 mm PITCH	60	150
M6 1.0 mm PITCH	65	150
M6 1.0 mm PITCH	70	150
M6 1.0 mm PITCH	75	150
M6 1.0 mm PITCH	80	150



HEXAGON HEAD M6 1.0mm PITCH BOLTS & NUTS

CLASS 8.8 AS 1110 – 2000 / AS 1112 – 2000

ZINC PLATED

DIAMETER mm	LENGTH mm	STANDARD PACK
M6 1.0 mm PITCH	12	200
M6 1.0 mm PITCH	16	200
M6 1.0 mm PITCH	20	200
M6 1.0 mm PITCH	25	200
M6 1.0 mm PITCH	30	200
M6 1.0 mm PITCH	35	200
M6 1.0 mm PITCH	40	200
M6 1.0 mm PITCH	45	200
M6 1.0 mm PITCH	50	200
M6 1.0 mm PITCH	55	150
M6 1.0 mm PITCH	60	150
M6 1.0 mm PITCH	65	150
M6 1.0 mm PITCH	70	150
M6 1.0 mm PITCH	75	150
M6 1.0 mm PITCH	80	150

HEXAGON HEAD M8 1.25mm PITCH



BOLTS & NUTS

CLASS 8.8 AS 1110 – 2000 / AS 1112 – 2000

BLACK

DIAMETER mm	LENGTH mm	STANDARD PACK
M8 1.25 mm PITCH	12	200
M8 1.25 mm PITCH	16	200
M8 1.25 mm PITCH	20	200
M8 1.25 mm PITCH	25	200
M8 1.25 mm PITCH	30	200
M8 1.25 mm PITCH	35	200
M8 1.25 mm PITCH	40	200

M8 1.25 mm PITCH	45	150
M8 1.25 mm PITCH	50	150
M8 1.25 mm PITCH	55	150
M8 1.25 mm PITCH	60	150
M8 1.25 mm PITCH	65	150
M8 1.25 mm PITCH	70	100
M8 1.25 mm PITCH	70	100
M8 1.25 mm PITCH	75	100
M8 1.25 mm PITCH	80	100
M8 1.25 mm PITCH	85	100
M8 1.25 mm PITCH	90	100
M8 1.25 mm PITCH	95	100
M8 1.25 mm PITCH	100	100
M8 1.25 mm PITCH	110	100
M8 1.25 mm PITCH	120	100
M8 1.25 mm PITCH	130	100

HEXAGON HEAD M8 1.25mm PITCH



BOLTS & NUTS

CLASS 8.8 AS 1110 – 2000 / AS 1112 – 2000

ZINC PLATED

DIAMETER
mm

LENGTH
mm

STANDARD
PACK

M8 1.25 mm PITCH	12	200
M8 1.25 mm PITCH	16	200
M8 1.25 mm PITCH	20	200
M8 1.25 mm PITCH	25	200
M8 1.25 mm PITCH	30	200
M8 1.25 mm PITCH	35	200
M8 1.25 mm PITCH	40	200
M8 1.25 mm PITCH	45	150
M8 1.25 mm PITCH	50	150
M8 1.25 mm PITCH	55	150
M8 1.25 mm PITCH	60	150
M8 1.25 mm PITCH	65	150
M8 1.25 mm PITCH	70	100
M8 1.25 mm PITCH	70	100
M8 1.25 mm PITCH	75	100

M8 1.25 mm PITCH	80	100
M8 1.25 mm PITCH	85	100
M8 1.25 mm PITCH	90	100
M8 1.25 mm PITCH	95	100
M8 1.25 mm PITCH	100	100
M8 1.25 mm PITCH	110	100
M8 1.25 mm PITCH	120	100
M8 1.25 mm PITCH	130	100

HEXAGON HEAD M10 1.5mm PITCH



BOLTS & NUTS

CLASS 8.8 AS 1110 – 2000 / AS 1112 – 2000

BLACK

DIAMETER mm	LENGTH mm	STANDARD PACK
M10 1.5 mm PITCH	12	150
M10 1.5 mm PITCH	16	150
M10 1.5 mm PITCH	20	150
M10 1.5 mm PITCH	25	150
M10 1.5 mm PITCH	30	150
M10 1.5 mm PITCH	35	150
M10 1.5 mm PITCH	40	150
M10 1.5 mm PITCH	45	150
M10 1.5 mm PITCH	50	75
M10 1.5 mm PITCH	55	75
M10 1.5 mm PITCH	60	75
M10 1.5 mm PITCH	65	75
M10 1.5 mm PITCH	70	75
M10 1.5 mm PITCH	75	75
M10 1.5 mm PITCH	80	75
M10 1.5 mm PITCH	85	75
M10 1.5 mm PITCH	90	50
M10 1.5 mm PITCH	100	50
M10 1.5 mm PITCH	110	50
M10 1.5 mm PITCH	120	50
M10 1.5 mm PITCH	130	50
M10 1.5 mm PITCH	140	50
M10 1.5 mm PITCH	150	50

M10 1.5 mm PITCH	160	50
M10 1.5 mm PITCH	170	50
M10 1.5 mm PITCH	180	25
M10 1.5 mm PITCH	190	25
M10 1.5 mm PITCH	200	25

HEXAGON HEAD M10 1.5mm PITCH



BOLTS & NUTS

CLASS 8.8 AS 1110 – 2000 / AS 1112 – 2000
ZINC PLATED

DIAMETER mm	LENGTH mm	STANDARD PACK
----------------	--------------	------------------

M10 1.5 mm PITCH	12	150
M10 1.5 mm PITCH	16	150
M10 1.5 mm PITCH	20	150
M10 1.5 mm PITCH	25	150
M10 1.5 mm PITCH	30	150
M10 1.5 mm PITCH	35	150
M10 1.5 mm PITCH	40	150
M10 1.5 mm PITCH	45	150
M10 1.5 mm PITCH	50	75
M10 1.5 mm PITCH	55	75
M10 1.5 mm PITCH	60	75
M10 1.5 mm PITCH	65	75
M10 1.5 mm PITCH	70	75
M10 1.5 mm PITCH	75	75
M10 1.5 mm PITCH	80	75
M10 1.5 mm PITCH	85	75
M10 1.5 mm PITCH	90	50
M10 1.5 mm PITCH	100	50
M10 1.5 mm PITCH	110	50
M10 1.5 mm PITCH	120	50
M10 1.5 mm PITCH	130	50
M10 1.5 mm PITCH	140	50
M10 1.5 mm PITCH	150	50
M10 1.5 mm PITCH	160	50
M10 1.5 mm PITCH	170	50
M10 1.5 mm PITCH	180	25
M10 1.5 mm PITCH	190	25
M10 1.5 mm PITCH	200	25

HEXAGON HEAD M12 1.75mm PITCH



BOLTS & NUTS

CLASS 8.8 AS 1110 – 2000 / AS 1112 – 2000

BLACK

DIAMETER
mm

LENGTH
mm

STANDARD
PACK

DIAMETER mm	LENGTH mm	STANDARD PACK
M12 1.75 mm PITCH	20	75
M12 1.75 mm PITCH	25	75
M12 1.75 mm PITCH	30	75
M12 1.75 mm PITCH	35	75
M12 1.75 mm PITCH	40	75
M12 1.75 mm PITCH	45	75
M12 1.75 mm PITCH	50	50
M12 1.75 mm PITCH	55	50
M12 1.75 mm PITCH	60	50
M12 1.75 mm PITCH	65	50
M12 1.75 mm PITCH	70	50
M12 1.75 mm PITCH	75	50
M12 1.75 mm PITCH	80	25
M12 1.75 mm PITCH	85	25
M12 1.75 mm PITCH	90	25
M12 1.75 mm PITCH	100	25
M12 1.75 mm PITCH	110	25
M12 1.75 mm PITCH	120	25
M12 1.75 mm PITCH	130	25
M12 1.75 mm PITCH	140	25
M12 1.75 mm PITCH	150	25
M12 1.75 mm PITCH	160	20
M12 1.75 mm PITCH	170	20
M12 1.75 mm PITCH	180	20
M12 1.75 mm PITCH	190	20
M12 1.75 mm PITCH	200	20

HEXAGON HEAD M12 1.75mm PITCH



BOLTS & NUTS

CLASS 8.8 AS 1110 – 2000 / AS 1112 – 2000

ZINC PLATED

DIAMETER

LENGTH

STANDARD

mm

mm

PACK

DIAMETER	LENGTH	STANDARD
mm	mm	PACK
M12 1.75 mm PITCH	20	75
M12 1.75 mm PITCH	25	75
M12 1.75 mm PITCH	30	75
M12 1.75 mm PITCH	35	75
M12 1.75 mm PITCH	40	75
M12 1.75 mm PITCH	45	75
M12 1.75 mm PITCH	50	50
M12 1.75 mm PITCH	55	50
M12 1.75 mm PITCH	60	50
M12 1.75 mm PITCH	65	50
M12 1.75 mm PITCH	70	50
M12 1.75 mm PITCH	75	50
M12 1.75 mm PITCH	80	25
M12 1.75 mm PITCH	85	25
M12 1.75 mm PITCH	90	25
M12 1.75 mm PITCH	100	25
M12 1.75 mm PITCH	110	25
M12 1.75 mm PITCH	120	25
M12 1.75 mm PITCH	130	25
M12 1.75 mm PITCH	140	25
M12 1.75 mm PITCH	150	25
M12 1.75 mm PITCH	160	20
M12 1.75 mm PITCH	170	20
M12 1.75 mm PITCH	180	20
M12 1.75 mm PITCH	190	20
M12 1.75 mm PITCH	200	20

HEXAGON HEAD M12 1.75mm PITCH



BOLTS & NUTS

CLASS 8.8 AS 1110 – 2000 / AS 1112 – 2000

GALVANISED

DIAMETER mm	LENGTH mm	STANDARD PACK
M12 1.75 mm PITCH	30	75
M12 1.75 mm PITCH	40	75
M12 1.75 mm PITCH	50	50

HEXAGON HEAD M16 2.0mm PITCH



BOLTS & NUTS

CLASS 8.8 AS 1110 – 2000 / AS 1112 – 2000 BLACK

DIAMETER mm	LENGTH mm	STANDARD PACK
M16 2.0 mm PITCH	25	25
M16 2.0 mm PITCH	30	25
M16 2.0 mm PITCH	35	25
M16 2.0 mm PITCH	40	25
M16 2.0 mm PITCH	45	25
M16 2.0 mm PITCH	50	25
M16 2.0 mm PITCH	55	25
M16 2.0 mm PITCH	60	25
M16 2.0 mm PITCH	65	25
M16 2.0 mm PITCH	70	25
M16 2.0 mm PITCH	75	25
M16 2.0 mm PITCH	80	25
M16 2.0 mm PITCH	85	25
M16 2.0 mm PITCH	90	25
M16 2.0 mm PITCH	100	25
M16 2.0 mm PITCH	110	15
M16 2.0 mm PITCH	120	15

M16 2.0 mm PITCH	130	15
M16 2.0 mm PITCH	140	15
M16 2.0 mm PITCH	150	15
M16 2.0 mm PITCH	160	15
M16 2.0 mm PITCH	170	15
M16 2.0 mm PITCH	180	15
M16 2.0 mm PITCH	190	15
M16 2.0 mm PITCH	200	15
M16 2.0 mm PITCH	210	10
M16 2.0 mm PITCH	220	10
M16 2.0 mm PITCH	230	10
M16 2.0 mm PITCH	240	10
M16 2.0 mm PITCH	250	10

HEXAGON HEAD M16 2.0mm PITCH



BOLTS & NUTS

CLASS 8.8 AS 1110 – 2000 / AS 1112 – 2000

ZINC PLATED

DIAMETER mm	LENGTH mm	STANDARD PACK
M16 2.0 mm PITCH	25	25
M16 2.0 mm PITCH	30	25
M16 2.0 mm PITCH	35	25
M16 2.0 mm PITCH	40	25
M16 2.0 mm PITCH	45	25
M16 2.0 mm PITCH	50	25
M16 2.0 mm PITCH	55	25
M16 2.0 mm PITCH	60	25
M16 2.0 mm PITCH	65	25
M16 2.0 mm PITCH	70	25
M16 2.0 mm PITCH	75	25
M16 2.0 mm PITCH	80	25
M16 2.0 mm PITCH	85	25
M16 2.0 mm PITCH	90	25
M16 2.0 mm PITCH	100	25
M16 2.0 mm PITCH	110	15
M16 2.0 mm PITCH	120	15
M16 2.0 mm PITCH	130	15

M16 2.0 mm PITCH	140	15
M16 2.0 mm PITCH	150	15
M16 2.0 mm PITCH	160	15
M16 2.0 mm PITCH	170	15
M16 2.0 mm PITCH	180	15
M16 2.0 mm PITCH	190	15
M16 2.0 mm PITCH	200	15
M16 2.0 mm PITCH	210	10
M16 2.0 mm PITCH	220	10
M16 2.0 mm PITCH	230	10
M16 2.0 mm PITCH	240	10
M16 2.0 mm PITCH	250	10

HEXAGON HEAD M20 2.5mm PITCH**BOLTS & NUTS**

CLASS 8.8 AS 1110 – 2000 / AS 1112 – 2000

BLACK

DIAMETER

LENGTH

STANDARD

mm

mm

PACK

M20 2.5 mm PITCH	40	25
M20 2.5 mm PITCH	45	25
M20 2.5 mm PITCH	50	25
M20 2.5 mm PITCH	55	25
M20 2.5 mm PITCH	60	25
M20 2.5 mm PITCH	65	20
M20 2.5 mm PITCH	65	20
M20 2.5 mm PITCH	70	20
M20 2.5 mm PITCH	75	20
M20 2.5 mm PITCH	80	20
M20 2.5 mm PITCH	85	20
M20 2.5 mm PITCH	90	20
M20 2.5 mm PITCH	100	10
M20 2.5 mm PITCH	110	10
M20 2.5 mm PITCH	120	10
M20 2.5 mm PITCH	130	10
M20 2.5 mm PITCH	140	10
M20 2.5 mm PITCH	150	10
M20 2.5 mm PITCH	160	10
M20 2.5 mm PITCH	170	10
M20 2.5 mm PITCH	180	10
M20 2.5 mm PITCH	190	10
M20 2.5 mm PITCH	200	10
M20 2.5 mm PITCH	220	5
M20 2.5 mm PITCH	230	5
M20 2.5 mm PITCH	240	5
M20 2.5 mm PITCH	250	5

HEXAGON HEAD M20 2.5mm PITCH**BOLTS & NUTS**

CLASS 8.8 AS 1110 – 2000 / AS 1112 – 2000

ZINC PLATED

DIAMETER

LENGTH

STANDARD

mm

mm

PACK

M20 2.5 mm PITCH	40	25
M20 2.5 mm PITCH	45	25
M20 2.5 mm PITCH	50	25
M20 2.5 mm PITCH	55	25
M20 2.5 mm PITCH	60	25
M20 2.5 mm PITCH	65	20
M20 2.5 mm PITCH	65	20
M20 2.5 mm PITCH	70	20
M20 2.5 mm PITCH	75	20
M20 2.5 mm PITCH	80	20
M20 2.5 mm PITCH	85	20
M20 2.5 mm PITCH	90	20
M20 2.5 mm PITCH	100	10
M20 2.5 mm PITCH	110	10
M20 2.5 mm PITCH	120	10
M20 2.5 mm PITCH	130	10
M20 2.5 mm PITCH	140	10
M20 2.5 mm PITCH	150	10
M20 2.5 mm PITCH	160	10
M20 2.5 mm PITCH	170	10
M20 2.5 mm PITCH	180	10
M20 2.5 mm PITCH	190	10
M20 2.5 mm PITCH	200	10
M20 2.5 mm PITCH	220	5
M20 2.5 mm PITCH	230	5
M20 2.5 mm PITCH	240	5
M20 2.5 mm PITCH	250	5

HEXAGON HEAD M24 3.0mm PITCH



BOLTS & NUTS

CLASS 8.8 AS 1110 – 2000 / AS 1112 – 2000

BLACK
 STANDARD
 PACK

DIAMETER mm	LENGTH mm	BLACK STANDARD PACK
M20 2.5 mm PITCH	50	5
M20 2.5 mm PITCH	55	5
M20 2.5 mm PITCH	60	5
M20 2.5 mm PITCH	65	5
M20 2.5 mm PITCH	70	5
M20 2.5 mm PITCH	75	5
M20 2.5 mm PITCH	80	5
M20 2.5 mm PITCH	90	5
M20 2.5 mm PITCH	100	5
M20 2.5 mm PITCH	110	5
M20 2.5 mm PITCH	120	5
M20 2.5 mm PITCH	130	5
M20 2.5 mm PITCH	140	5
M20 2.5 mm PITCH	150	5
M20 2.5 mm PITCH	160	5
M20 2.5 mm PITCH	170	5
M20 2.5 mm PITCH	180	5
M20 2.5 mm PITCH	190	5
M20 2.5 mm PITCH	200	5
M20 2.5 mm PITCH	210	5
M20 2.5 mm PITCH	220	5
M20 2.5 mm PITCH	230	5
M20 2.5 mm PITCH	240	5
M20 2.5 mm PITCH	250	5

HEXAGON HEAD M24 3.0mm PITCH



BOLTS & NUTS

CLASS 8.8 AS 1110 – 2000 / AS 1112 – 2000

ZINC PLATED

DIAMETER

LENGTH

STANDARD

mm

mm

PACK

DIAMETER	LENGTH	STANDARD
mm	mm	PACK
M20 2.5 mm PITCH	50	5
M20 2.5 mm PITCH	55	5
M20 2.5 mm PITCH	60	5
M20 2.5 mm PITCH	65	5
M20 2.5 mm PITCH	70	5
M20 2.5 mm PITCH	75	5
M20 2.5 mm PITCH	80	5
M20 2.5 mm PITCH	90	5
M20 2.5 mm PITCH	100	5
M20 2.5 mm PITCH	110	5
M20 2.5 mm PITCH	120	5
M20 2.5 mm PITCH	130	5
M20 2.5 mm PITCH	140	5
M20 2.5 mm PITCH	150	5
M20 2.5 mm PITCH	160	5
M20 2.5 mm PITCH	170	5
M20 2.5 mm PITCH	180	5
M20 2.5 mm PITCH	190	5
M20 2.5 mm PITCH	200	5
M20 2.5 mm PITCH	210	5
M20 2.5 mm PITCH	220	5
M20 2.5 mm PITCH	230	5
M20 2.5 mm PITCH	240	5
M20 2.5 mm PITCH	250	5

HEXAGON HEAD M30 3.5mm PITCH



BOLTS & NUTS

CLASS 8.8 AS 1110 – 2000 / AS 1112 – 2000

ZINC PLATED

DIAMETER

LENGTH

STANDARD

mm

mm

PACK

DIAMETER	LENGTH	STANDARD
mm	mm	PACK
M30 3.5 mm PITCH	70	5
M30 3.5 mm PITCH	75	5
M30 3.5 mm PITCH	80	5
M30 3.5 mm PITCH	85	5
M30 3.5 mm PITCH	90	5
M30 3.5 mm PITCH	100	5
M30 3.5 mm PITCH	110	5
M30 3.5 mm PITCH	120	5
M30 3.5 mm PITCH	130	5
M30 3.5 mm PITCH	140	5
M30 3.5 mm PITCH	150	5
M30 3.5 mm PITCH	160	5
M30 3.5 mm PITCH	170	5
M30 3.5 mm PITCH	180	5
M30 3.5 mm PITCH	190	5
M30 3.5 mm PITCH	200	5
M30 3.5 mm PITCH	210	5
M30 3.5 mm PITCH	220	5
M30 3.5 mm PITCH	230	5
M30 3.5 mm PITCH	240	5
M30 3.5 mm PITCH	250	5

HEXAGON HEAD M6 1.0mm PITCH



SET SCREWS

CLASS 8.8 AS 1110 – 2000

ZINC PLATED

DIAMETER

LENGTH

STANDARD

mm

mm

PACK

M6 1.0 mm PITCH	12	200
M6 1.0 mm PITCH	16	200
M6 1.0 mm PITCH	20	200
M6 1.0 mm PITCH	25	200
M6 1.0 mm PITCH	30	200
M6 1.0 mm PITCH	35	200
M6 1.0 mm PITCH	40	200
M6 1.0 mm PITCH	45	200
M6 1.0 mm PITCH	50	200

HEXAGON HEAD M8 1.25mm PITCH



SET SCREWS

CLASS 8.8 AS 1110 – 2000

ZINC PLATED

DIAMETER

LENGTH

STANDARD

mm

mm

PACK

M8 1.25 mm PITCH	12	200
M8 1.25 mm PITCH	16	200
M8 1.25 mm PITCH	20	200
M8 1.25 mm PITCH	25	200
M8 1.25 mm PITCH	30	200
M8 1.25 mm PITCH	35	200
M8 1.25 mm PITCH	40	200
M8 1.25 mm PITCH	45	150
M8 1.25 mm PITCH	50	150
M8 1.25 mm PITCH	55	150
M8 1.25 mm PITCH	60	150
M8 1.25 mm PITCH	65	150
M8 1.25 mm PITCH	70	100
M8 1.25 mm PITCH	75	100
M8 1.25 mm PITCH	100	100

HEXAGON HEAD M10 1.5mm PITCH



SET SCREWS

CLASS 8.8 AS 1110 – 2000

ZINC PLATED

DIAMETER

LENGTH

STANDARD

mm

mm

PACK

M10 1.5 mm PITCH	12	150
M10 1.5 mm PITCH	16	150
M10 1.5 mm PITCH	20	150
M10 1.5 mm PITCH	25	150
M10 1.5 mm PITCH	30	150
M10 1.5 mm PITCH	35	150
M10 1.5 mm PITCH	40	150
M10 1.5 mm PITCH	45	150
M10 1.5 mm PITCH	50	150

HEXAGON HEAD M12 1.75mm PITCH



SET SCREWS

CLASS 8.8 AS 1110 – 2000

ZINC PLATED

DIAMETER

LENGTH

STANDARD

mm

mm

PACK

M12 1.75 mm PITCH	20	100
M12 1.75 mm PITCH	25	100
M12 1.75 mm PITCH	30	100
M12 1.75 mm PITCH	35	100
M12 1.75 mm PITCH	40	100
M12 1.75 mm PITCH	45	75
M12 1.75 mm PITCH	50	75
M12 1.75 mm PITCH	55	50
M12 1.75 mm PITCH	60	50
M12 1.75 mm PITCH	65	25
M12 1.75 mm PITCH	70	25
M12 1.75 mm PITCH	75	25

HEXAGON HEAD M16 2.0mm PITCH**SET SCREWS**

CLASS 8.8 AS 1110 – 2000

ZINC PLATED

DIAMETER

LENGTH

STANDARD

mm

mm

PACK

M16 2.0 mm PITCH	30	25
M16 2.0 mm PITCH	35	25
M16 2.0 mm PITCH	40	25
M16 2.0 mm PITCH	45	25
M16 2.0 mm PITCH	50	25
M16 2.0 mm PITCH	55	25
M16 2.0 mm PITCH	60	25
M16 2.0 mm PITCH	65	25
M16 2.0 mm PITCH	70	25
M16 2.0 mm PITCH	75	25

**THREADED ROD 1 METRE**

METRIC 4.6 DIN 975

BLACK

DIAMETER

LENGTH

STANDARD

mm

mm

PACK

M3		20
M4		20
M5		20
M6		20
M8		20
M10		20
M12		10
M16		10
M20		5
M24		5
M30		1
M36		1
M42		1
M48		1
M56		1
M64		1



THREADED ROD 1 METRE

METRIC 4.6 DIN 975
 DIAMETER
 mm

GALVANISED
 LENGTH
 mm

STANDARD
 PACK

M10	20
M12	10
M16	10
M20	5
M24	5
M30	1
M36	1
M42	1
M48	1
M56	1
M64	1



THREADED ROD 1 METRE

METRIC 4.6 DIN 975
 DIAMETER
 mm

ZINC PLATED
 LENGTH
 mm

STANDARD
 PACK

M3	20
M4	20
M5	20
M6	20
M8	20
M10	20
M12	10
M16	10
M20	5
M24	5
M30	1
M36	1
M42	1
M48	1



THREADED ROD 3 METRE

METRIC 4.6 DIN 975

BLACK

DIAMETER

LENGTH

STANDARD

mm

mm

PACK

M6		20
M8		20
M10		20
M12		10
M16		10
M20		5
M24		5
M30		1
M36		1



THREADED ROD 3 METRE

METRIC 4.6 DIN 975

GALVANISED

DIAMETER

LENGTH

STANDARD

mm

mm

PACK

M10		20
M12		10
M16		10
M20		5
M24		5
M30		1
M36		1



THREADED ROD 3 METRE

METRIC 4.6 DIN 975

ZINC PLATED

DIAMETER
mm

LENGTH
mm

STANDARD
PACK

M6	20
M8	20
M10	20
M12	10
M16	10
M20	5
M24	5
M30	1
M36	1



THREADED ROD 1 METRE

CLASS 8.8 DIN 975

BLACK

DIAMETER
mm

LENGTH
mm

STANDARD
PACK

M6	20
M8	20
M10	20
M12	10
M16	10
M20	5
M24	5
M30	1
M36	1
M42	1
M48	1



THREADED ROD 1 METRE

CLASS 8.8 DIN 975

GALVANISED

DIAMETER

LENGTH

STANDARD

mm

mm

PACK

M10	20
M12	10
M16	10
M20	5
M24	5
M30	1
M36	1



THREADED ROD 3 METRE

CLASS 8.8 DIN 975

GALVANISED

DIAMETER

LENGTH

STANDARD

mm

mm

PACK

M12	10
M16	10
M20	5
M24	5
M30	2
M36	1



HEX COUPLING NUTS

METRIC GALVANISED

DIAMETER mm	LENGTH mm	STANDARD PACK
M10	40	100
M12	40	100
M16	50	50
M20	70	25
M24	70	20
M30	70	5
M36	70	5

HEX COUPLING NUTS

METRIC ZINC PLATED

DIAMETER mm	LENGTH mm	STANDARD PACK
M6	25	100
M8	25	100
M10	40	100
M12	40	100
M16	50	50
M20	50	25
M24	50	20
M30	70	5
M36	70	5



HEXAGON NUTS

CLASS 8 METRIC AS 1112 - 2000 BLACK BULK

DIAMETER

mm

STANDARD
PACK

M5	1000
M6	1000
M8	1000
M10	500
M12	500
M16	200
M20*	100
M24*	50

*Class 5 Style 2



HEXAGON NUTS

CLASS 8 METRIC AS 1112 - 2000 GALVANISED BULK

DIAMETER

mm

STANDARD
PACK

M6	1000
M8	1000
M10	500
M12	500
M16	200
M20*	100
M24*	50

*Style 2



HEXAGON NUTS

CLASS 8 METRIC AS 1112 - 2000 ZINC PLATED BULK

DIAMETER

mm

STANDARD
PACK

M3*	1000
M4*	1000
M5*	1000
M6	1000
M8	1000
M10	500
M12	500
M16	200
M20*	100
M24*	50

*Class 5 Style 2



HEXAGON NUTS

CLASS 8 METRIC AS 1112 - 2000 BLACK BULK

DIAMETER

mm

STANDARD
PACK

M5*	10000
M6	5000
M8	3000
M10	2000
M12	800
M16	400
M20*	250
M24*	150
M30*	75

*Class 5 Style 2

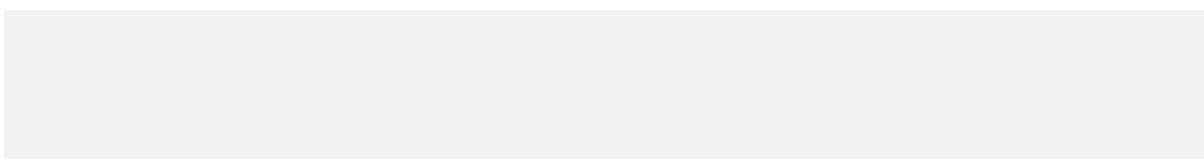



HEXAGON NUTS

CLASS 8 METRIC AS 1112 - 2000 GALVANISED BULK

DIAMETER

mm

STANDARD
PACK

M6	5000
M8	3000
M10	2000
M12	800
M16	400
M20*	250
M24*	150

*Class 5 Style 2



HEXAGON NUTS

CLASS 8 METRIC AS 1112 - 2000 ZINC PLATED BULK

DIAMETER

mm

STANDARD
PACK

M3*	10000
M4*	10000
M5*	10000
M6	5000
M8	3000
M10	2000
M12	800
M16	400
M20*	250
M24*	150

*Class 5 Style 2



HEXAGON NUTS

CLASS 5 METRIC AS 1112 - 2000 BLACK BULK

DIAMETER

mm

STANDARD
PACK

M30	100
M33	50
M36	50
M42	25
M48	25
M56	15
M64	5



HEXAGON NUTS

CLASS 5 METRIC AS 1112 - 2000 GALVANISED BULK

DIAMETER

mm

STANDARD
PACK

M30	100
M33	50
M36	50
M42	25
M48	25
M56	15
M64	510



FLAT ROUND WASHERS

GALVANISED – BLACK – ZINC PLATED

NOMINAL SIZE mm	STANDARD PACK
6mm	5000
8mm	3000
10mm	2000
12mm	800
16mm	400
20mm	250
22mm	250
24mm	150
27mm	100
30mm	75
33mm	50
36mm	40
42mm	40
48mm	30



FLAT ROUND WASHERS

MILD STEEL AS 1237 GALVANISED – BLACK

NOMINAL SIZE mm	STANDARD PACK
30mm	75
36mm	40
42mm	40
48mm	30
56mm	30
64mm	30
72mm	20



SQUARE FLAT WASHERS

MILD STEEL GALVANISED – ZINC PLATED

NOMINAL SIZE	NOMINAL HOLE DIAMETER mm	BOLT DIAMETER mm	STANDARD PACK
40 x 40 x 3	12	10	250
50 x 50 x 3	13.5	12	250
50 x 50 x 3	18	16	200
50 x 50 x 6	18	16	100
65 x 65 x 5	18	16	50
50 x 50 x 3	22	20	50
75 x 75 x 6	22	20	50
75 x 75 x 6	26	24	50



TURNBUCKLES

SIZE	STANDARD PACK
T/BKLE STUB/E-GAL BODY: M12 X 125	50
T/BKLE STUB/E-GAL BODY: M16 X 170	30
T/BKLE STUB/E-GAL BODY: M20 X 200	20
T/BKLE STUB/E-GAL BODY: M24 X 255	10
T/BKLE STUB/E-GAL BODY: M30 X 255	5
T/BKLE STUB/E-GAL BODY: M32 X 255	2



PURLIN FACIA BOLT

DIAMETER	GRADE	STANDARD PACK
M12 X 30	Z/P 4.6 PURLIN	400
M12 X 30	Z/P 4.6 FASCIA	300
M12 X 30	Z/P 4.6 FLANGED	300
M12 X 30	Z/P 8.8 FLANGED	400
M12 X 30	GAL 4.6 PURLIN	400
M12 X 30	GAL 4.6 FLANGED	300
M12 X 30	GAL 8.8 PURLIN	300
M12 X 30	GAL 8.8 FLANGED	300
M16 X 30	Z/P 4.6 PURLIN	160
M16 X 30	Z/P 4.6 FASCIA	160
M16 X 30	Z/P 4.6 FLANGED	160

STANDARD ROUND FERRULES (ZINC)



DESCRIPTION

QTY PER BOX

12mm x 96mm Round Ferrule	50
16mm x 76mm Round Ferrule	50
16mm x 96mm Round Ferrule	50
20mm x 76mm Round Ferrule	50
20mm x 96mm Round Ferrule	50
24mm x 100mm Round Ferrule	25

STANDARD ROUND FERRULES (GALVANISED)



DESCRIPTION

QTY PER BOX

12mm x 96mm Round Ferrule	50
16mm x 96mm Round Ferrule	50
20mm x 96mm Round Ferrule	50

STANDARD ROUND FERRULES (S/S)



DESCRIPTION

QTY PER BOX

16mm x 96mm Round Ferrule	50
20mm x 96mm Round Ferrule	50

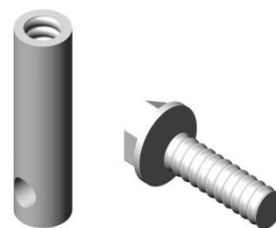

BRACING FERRULES & BOLT

<i>3/4 x 96mm Bracing Ferrule</i>	50
<i>3/4 x 65mm Bracing Ferrule</i>	50

ELEPHANT FOOT FERRULES (ZINC)



DESCRIPTION	QTY PER BOX
<i>12mm x 55mm Elephant Foot Ferrule</i>	200
<i>12mm x 96mm Elephant Foot Ferrule</i>	50
<i>16mm x 70mm Elephant Foot Ferrule</i>	50
<i>16mm x 96mm Elephant Foot Ferrule</i>	50
<i>20mm x 70mm Elephant Foot Ferrule</i>	50
<i>20mm x 96mm Elephant Foot Ferrule</i>	50
<i>24mm x 96mm Elephant Foot Ferrule</i>	50

ELEPHANT FOOT FERRULES (GALVANISED)



DESCRIPTION

QTY PER BOX

<i>12mm x 55mm Elephant Foot Ferrule</i>	<i>200</i>
<i>12mm x 96mm Elephant Foot Ferrule</i>	<i>50</i>
<i>16mm x 70mm Elephant Foot Ferrule</i>	<i>50</i>
<i>16mm x 96mm Elephant Foot Ferrule</i>	<i>50</i>
<i>20mm x 70mm Elephant Foot Ferrule</i>	<i>50</i>
<i>20mm x 96mm Elephant Foot Ferrule</i>	<i>50</i>
<i>24mm x 96mm Elephant Foot Ferrule</i>	<i>50</i>

DOUBLE ENDED FERRULES ROUND (ZINC)



DESCRIPTION

QTY PER BOX

<i>12mm x 140mm to suit 150mm Panel</i>	<i>50</i>
<i>16mm x 140mm to suit 150mm Panel</i>	<i>50</i>
<i>16mm x 165mm to suit 175mm Panel</i>	<i>50</i>
<i>20mm x 140mm to suit 150mm Panel</i>	<i>50</i>
<i>20mm x 165mm to suit 175mm Panel</i>	<i>50</i>
<i>20mm x 190mm to suit 200mm Panel</i>	<i>50</i>

GROUT / SILICONE / SEALANTS / BACKER RODS

DESCRIPTION	QTY PER BOX
20kg Bag Panel Grout	1
12kg Aftek Lightweight Patching Mortar	1
20kg Bag Fairing Coat Patching Mortar	1
20kg Bag High Build Patching Mortar	1
Roof & Gutter Silicone Translucent	20
600ml Sika Flex Firate Sausage Grey	15
600ml Sika Flex Sausage Grey Construction J	20
30mm x 20mm Foam Open Cell Backer Rod	200



STARTER BARS

DESCRIPTION	QTY PER BOX
12mm x 600mm N Grade Starter Bar	15
16mm x 600mm N Grade Starter Bar	10
20mm x 600mm N Grade Starter Bar	9

GROUT TUBES, ACCESSORIES & CAPS

DESCRIPTION	QTY PER BOX
Grout Tubes to Suite 125mm Panel	100
Grout Tubes to Suite 150mm Panel	100
Grout Tubes to Suite 175mm Panel	100
Grout Tubes to Suite 200mm Panel	100
Grout Tube Extension 100mm	100
Grout Tube Extension 200mm	100
Grout Tube Elbow 90 degree	80
Grout Tubes Bar Chair to Suit 125 to 200mm	100
3M X 50mm Conduit per 3M Length	1
50mm Grout Locator Cap Red	100
50mm Grout End Cap Black	100

FACE LIFTER & BRACE FERRULE PATCH CAPS



DESCRIPTION	QTY PER BOX
5.0 Tonne Face Lift Patch Cap	200
20mm Ferrule Patch Cap	100

VENEZIA PANEL PROP BRACE HIRE



DESCRIPTION	Closed	Middle	Fully Open	Weight
Trench Mini Brace	1.0M @35kn	1.3M @30kn	1.7M @ 25kn	20kg
Mini Brace	2.2M @30kn	2.8M @20kn	3.4M @11kn	29kg
Mini 2 Brace	2.9M @30kn	3.3M @28kn	4.1M @ 25kn	39kg
Standard Brace	4.6M @20kn	5.4M @18kn	6.8M @ 15kn	56kg
Special Brace	5.4M @30kn	7.4M @25kn	9.0M @ 10kn	72kg
Jumbo Brace	6.4M @30kn	8.5M @15kn	11.5M@ 8kn	106kg
Super Jumbo	8.5M @26kn	11.5m @8kn	14.5M@ 4kn	141kg

Locks & Pins *Locks and Pin to Suit Panel Prop Braces – No Charge***

**** Locks and Pins are supplied with hire of Panel Brace's. If lost charges applies.**

ANGLE CONNECTION / FLAT PLATES PANEL CLIPS / BOLTS

DESCRIPTION	QTY PER BOX
Angle Connection Plate 150 x 200 x 90 x 12mm "Dip Painted Galvanised"	1
Fish Plate 330 x 90 x 10mm dip Painted Gal.	1
Panel Clip Galvanised 150 x 75 x 10mm	1
Panel Clip Galvanised 200 x 75 x 10mm	1
Panel Bolt M20 x 50 8.8 Grade Zinc Plated	1
Panel Bolt M20 x 60 8.8 Grade Zinc Plated	1
M20 Zinc Plated Structural Washer	1
M20 Galvanised Structural Washer	1
M20 Oversized Galvanised Structural Washer	1
Black Cast in Plates 200 x 200 With Zinc Ferrule	1
Galvanised Cast in Plates 200 x 200 With Ferrule	1
Galvanised Cast in Plates 200 x 200 Without Ferrule	1

FILLET / WINGED FILET / FALSE JOINT DOUBLE SIDED TAPES



DESCRIPTION	QTY PER BUNDLE
12mm Fillet Edging Strip	75
20mm Fillet Edging Strip	75
12mm Winged Filet	75
40mm Mock Joint	60
Tesa Double Sided Spots	800
24mm Double Sided Tape Tesa Brand	10
40mm Double Sided Tape Tesa Brand	5

FILLET CUTTER



DESCRIPTION	QTY PER BUNDLE
Fillet Cutter	1

DOWEL POCKETS / DOWEL INSERTS



DESCRIPTION	QTY PER
Re-Usable Dowel Pocket "Blue"	1
16mm Plastic Dowelsert Reid	1
20mm Plastic Dowelsert Reid	1

FOOT ANCHORS



DESCRIPTION	QTY PER BAG
1.3 Tonne x 35mm Cone Anchor	200
1.3 Tonne x 45mm Cone Anchor	200
1.3 Tonne x 55mm Cone Anchor	200
1.3 Tonne x 66mm Cone Anchor	200
1.3 Tonne x 85mm Cone Anchor	100
1.3 Tonne x 120mm Cone Anchor	100
1.3 Tonne x 240mm Cone Anchor	50
2.5 Tonne x 55mm Cone Anchor	100
2.5 Tonne x 75mm Cone Anchor	100
2.5 Tonne x 90mm Cone Anchor	50
2.5 Tonne x 120mm Cone Anchor	50
2.5 Tonne x 170mm Cone Anchor	25
2.5 Tonne x 280mm Cone Anchor	25
5.0 Tonne x 75mm Cone Anchor	50
5.0 Tonne x 95mm Cone Anchor	50
5.0 Tonne x 120mm Cone Anchor	50

5.0 Tonne x 170mm Cone Anchor	25
5.0 Tonne x 240mm Cone Anchor	25
10 Tonne x 150mm Cone Anchor	10
10 Tonne x 340mm Cone Anchor	5
20 Tonne x 340mm Cone Anchor	1
20 Tonne x 500mm Cone Anchor	1
32 Tonne x 700mm Cone Anchor	1

Available in 316 Grade Stainless Steel to Order

EYE ANCHORS



DESCRIPTION	QTY PER BAG
1.3 Tonne x 50mm Reo Anchor	200
1.3 Tonne x 65mm Reo Anchor	200
2.5 Tonne x 90mm Reo Anchor	100
5.0 Tonne x 90mm Reo Anchor	50
5.0 Tonne x 120mm Reo Anchor	25
10 Tonne x 180mm Reo Anchor	10
20 Tonne x 250mm Reo Anchor	5
32 Tonne x 300mm Reo Anchor	1

SWIFT LIFT LIFTING CLUTCHES

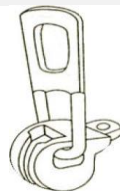

DESCRIPTION
1.3 Tonne Swift Lifting Clutch
2.5 Tonne Swift Lifting Clutch
5.0 Tonne Swift Lifting Clutch
10.0 Tonne Swift Lifting Clutch
20.0 Tonne Swift Lifting Clutch
32.0 Tonne Swift Lifting Clutch

RUBBER / STEEL RECESS FORMERS



DESCRIPTION

1.3 Tonne Rubber Recess Former

2.5 Tonne Rubber Recess Former

5.0 Tonne Rubber Recess Former

10.0 Tonne Rubber Recess Former

20.0 Tonne Rubber Recess Former

1.3 Tonne Rubber Recess Former - Round

2.5 Tonne Rubber Recess Former - Round

5.0 Tonne Rubber Recess Former - Round

PLASTIC RECESS FORMER



DESCRIPTION

2.5 Tonne Plastic Recess Former

5.0 Tonne Plastic Recess Former

ARTICULATED RECESS FORMER

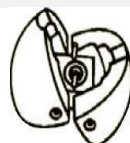

DESCRIPTION

1.3 Tonne Articulated Steel Recess Former

2.5 Tonne Articulated Steel Recess Former

5.0 Tonne Articulated Steel Recess Former

RUBBER RINGS



DESCRIPTION

1.3 Tonne Rubber Rings

2.5 Tonne Rubber Rings

5.0 Tonne Rubber Rings

2.5 & 5.0 TONNE FOOT STYLE EDGELIFT SYSTEM



DESCRIPTION

QTY PER BOX

2.5T x 170mm Edgelift Anchor

40

5.0T x 340mm Edgelift Anchor

20

HAIRPIN EDGELIFT SYSTEM



DESCRIPTION

5 Tonne Reid Edgelift Anchor

7 Tonne Reid Edgelift Anchor

10 Tonne Reid Edgelift Anchor

RAMSET TILT-UP SETS

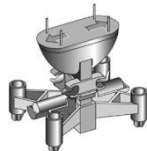

DESCRIPTION	QTY PER BOX
Face Lift Anchor for 100mm	16
Face Lift Anchor for 125mm	16
Face Lift Anchor for 150mm	16
Face Lift Anchor for 175mm	16
Face Lift Anchor for 200mm	16

REID TILT-UP SETS



DESCRIPTION	QTY PER BOX
Face Lift Anchor for 100mm	16
Face Lift Anchor for 125mm	16
Face Lift Anchor for 150mm	16
Face Lift Anchor for 175mm	16
Face Lift Anchor for 200mm	16

PANEL LEVER BAR



DESCRIPTION
Panel Lever Bar

BONDBREAKER / SPRAYER



DESCRIPTION

Reid Seal & Tilt Bondbreaker - 20 Litre

Reid Seal & Tilt Bondbreaker - 200 Litre

Unicon Bondbreaker – 208 Litre

Bondbreaker Sprayer

RAI055 Release Agent for Steel Beds

200 litre

CLIP-ON BAR CHAIRS



DESCRIPTION

QTY PER BOX

15mm x High – Suits 4-20mm Bar

100

20mm x High – Suits 4-20mm Bar

100

25mm x High – Suits 4-20mm Bar

100

30mm x High – Suits 4-20mm Bar

100

35mm x High – Suits 4-20mm Bar

100

40mm x High – Suits 4-20mm Bar

100

45mm x High – Suits 4-20mm Bar

100

50mm x High – Suits 4-20mm Bar

100

60mm x High – Suits 4-20mm Bar

100

65mm x High – Suits 4-20mm Bar

100

75mm x High – Suits 4-20mm Bar

100

CLIP-ON MESH CHAIRS

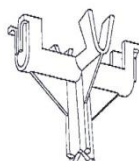

DESCRIPTION	QTY PER BOX
20mm x High For mesh Fabric	100
25mm x High For mesh Fabric	100
30mm x High For mesh Fabric	100
40mm x High For mesh Fabric	100
50mm x High For mesh Fabric	100
65mm x High For mesh Fabric	100
75mm x High For mesh Fabric	100

PANEL MESH CHAIRS



DESCRIPTION	QTY PER BOX
50mm/60mm Panel Mesh Chairs	100
65mm/75mm Panel Mesh Chairs	100

FERRULE CHAIRS

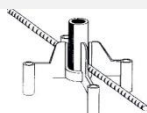

DESCRIPTION	QTY PER BOX
Ferrule Chair for 125mm	50
Ferrule Chair for 150mm	50
Ferrule Chair for 175mm	50
Ferrule Chair for 200mm	50
Ferrule Chair Extension 100mm	50

FERRULE CHAIR DOWELS

DESCRIPTION	QTY PER BAG
Ferrule Chair Dowels 85mm	100

PACKING SHIMS



DESCRIPTION

QTY PER BAG

<i>150mm x 100mm x 1mm Packing Shims</i>	<i>100</i>
<i>150mm x 100mm x 2mm Packing Shims</i>	<i>200</i>
<i>150mm x 100mm x 3mm Packing Shims</i>	<i>100</i>
<i>150mm x 100mm x 5mm Packing Shims</i>	<i>100</i>
<i>150mm x 100mm x 10mm Packing Shims</i>	<i>40</i>
<i>150mm x 100mm x 15mm Packing Shims</i>	<i>40</i>
<i>150mm x 100mm x 20mm Packing Shims</i>	<i>30</i>

HALF SHIMS



DESCRIPTION

QTY PER BAG

<i>75mm x 100mm x 1mm Packing Shims</i>	<i>200</i>
<i>75mm x 100mm x 2mm Packing Shims</i>	<i>400</i>
<i>75mm x 100mm x 3mm Packing Shims</i>	<i>200</i>
<i>75mm x 100mm x 5mm Packing Shims</i>	<i>200</i>
<i>75mm x 100mm x 10mm Packing Shims</i>	<i>80</i>
<i>75mm x 100mm x 15mm Packing Shims</i>	<i>80</i>
<i>75mm x 100mm x 20mm Packing Shims</i>	<i>60</i>

HORSE SHOE SHIMS LONG



DESCRIPTION	QTY PER BAG
150mm x 100mm Horse Shoe Shims 1mm	100
150mm x 100mm Horse Shoe Shims 2mm	200
150mm x 100mm Horse Shoe Shims 3mm	100
150mm x 100mm Horse Shoe Shims 5mm	100
150mm x 100mm Horse Shoe Shims 10mm	40
150mm x 100mm Horse Shoe Shims 15mm	40
150mm x 100mm Horse Shoe Shims 20mm	30

NAILING PLATES / GLUE ON PLATES



DESCRIPTION	QTY PER BAG
Nailing Plate for 12mm Ferrule	100
Nailing Plate for 16mm Ferrule	100
Nailing Plate for 20mm Ferrule	100
Nailing Plate for 24mm Ferrule	100
Glue On Nailing Plate for 12mm	100
Glue On Nailing Plate for 16mm	100
Glue On Nailing Plate for 20mm	100
Glue On Nailing Plate for 24mm	100
¾ Nailing Plate Bracing Insert	100

ANTENNA CAPS

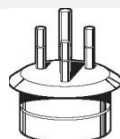

DESCRIPTION	QTY PER BAG
Antenna Caps For 12mm Ferrule	100
Antenna Caps For 16mm Ferrule	100
Antenna Caps For 20mm Ferrule	100
Antenna Caps For 24mm Ferrule	100